

Beach chair plan

The plan for this Folding Beach Chair is made by the model of a beach chair from the 1920s. Our model is almost a hundred years old, and the fact that his owners kept and used it for generations is the best proof that this beach chair remains contemporary and its time will never pass. This beach chair will fit by the pool side, in the garden or on the open porch. It is foldable, so it will be handy on the vacation by the sea or while camping by the river. Unlike plastic chairs – which are hard, uncomfortable and short-living – this beach chair will last at least 100 years. The only thing you would maybe like to do is to replace the fabric after several years. Choose some fabric with different color and you will have a brand new beach chair. The whole body is supported by fabric, which is attached onto a wooden frame only on the level of the feet and head, so the body is not in contact with the wooden frame and the fabric fully follows the line of the body providing maximal relaxation and comfort. The canopy provides protection from the sun, so the joy is complete. The chair has a comfortable rest for the feet, so you do not have to put your feet on the ground.

The beach chair is being made out of wood, it is assembled with fasteners and the seat and canopy are from one piece of the fabric. Some of the construction joints are movable, so the chair can be adjusted to a sitting or semi recumbent position. Changing these two positions can be done easily – while sitting in the chair, simply by moving the body. You should set at the position that suits you the best. Also, it can be folded completely, so it is very practical for transport or to store it in a small space when not in use.



Since it is designed for the outdoor use, we recommend that you make it out of wood that can tolerate various weather conditions, such as Eucalyptus, Western Red Cedar, Teak or similar wood, which is characterized by hardness and resistance to bending and is water resistant as well. There are numerous types of wood, mostly hardwoods that tolerate outdoor conditions. Find out which wood type with these properties you can get, because there are cheaper, local species of wood suitable for this purpose. A good finishing (like some oil-based product - finish with a fungicidal additive which will eliminate or reduce discoloration or any damage caused by mildew growth) will further extend the lifespan of wood. We also recommend that you use stainless steel fasteners or fasteners made out of some kind of an alloy that does not rust. You should pay special attention when selecting material for the fabric. It must be made out of sturdy cloth that will successfully carry body weight and tolerate the exposure to various weather conditions. The fabric is attaching onto the chairs *Upper* and *Lower Movable horizontal lath parts* through fabrics hem that should be sewn firmly. The piece of cloth that lies on the *Top horizontal lath* (Part 19) should be firmly attached with, for example the Velcro, so the wind could not move the piece of the cloth that has function of a sunshade. There are special materials that are being used for this purpose (canvas fabric, acrylic fabric, spun polyester fabric, olefin fabric ...), so we recommend using some of them. Maintenance of the cloth is simple – just wipe it with the wet rag and leave on the draft to dry.

When you do not use the chair, store it in a dry place. You should always dry it thoroughly before the storage, so it would not get ruined by water and microorganisms that could damage it. It is recommended to protect a wood at least once a year with some water-resistant coating.

Sub-assembly list

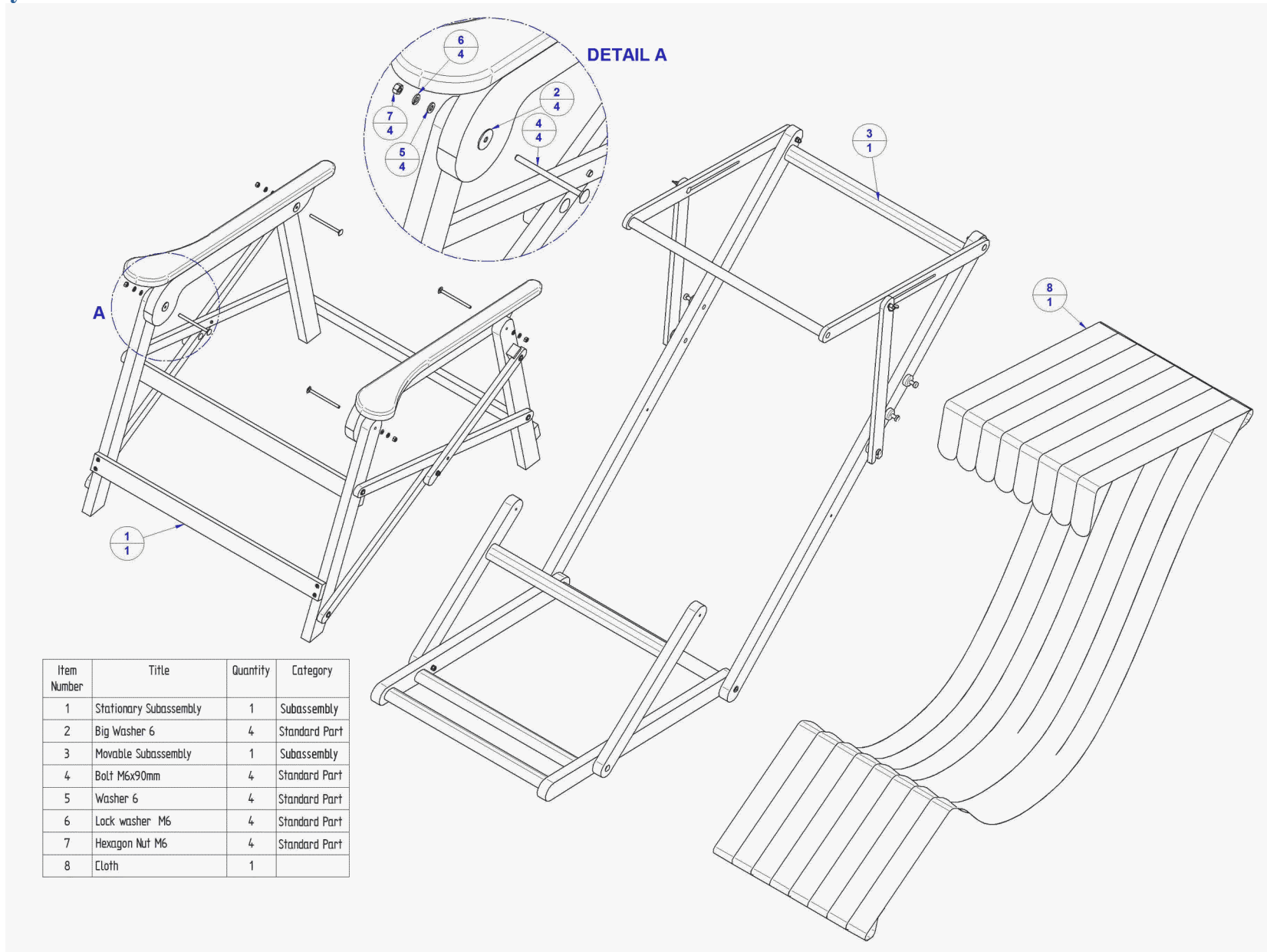

Item Number	Title	Quantity	Category
1	Stationary Subassembly	1	Subassembly
2	Big Washer 6	4	Standard Part
3	Movable Subassembly	1	Subassembly
4	Bolt M6x90mm	4	Standard Part
5	Washer 6	4	Standard Part
6	Lock washer M6	4	Standard Part
7	Hexagon Nut M6	4	Standard Part
8	Cloth	1	

Main assembly drawing

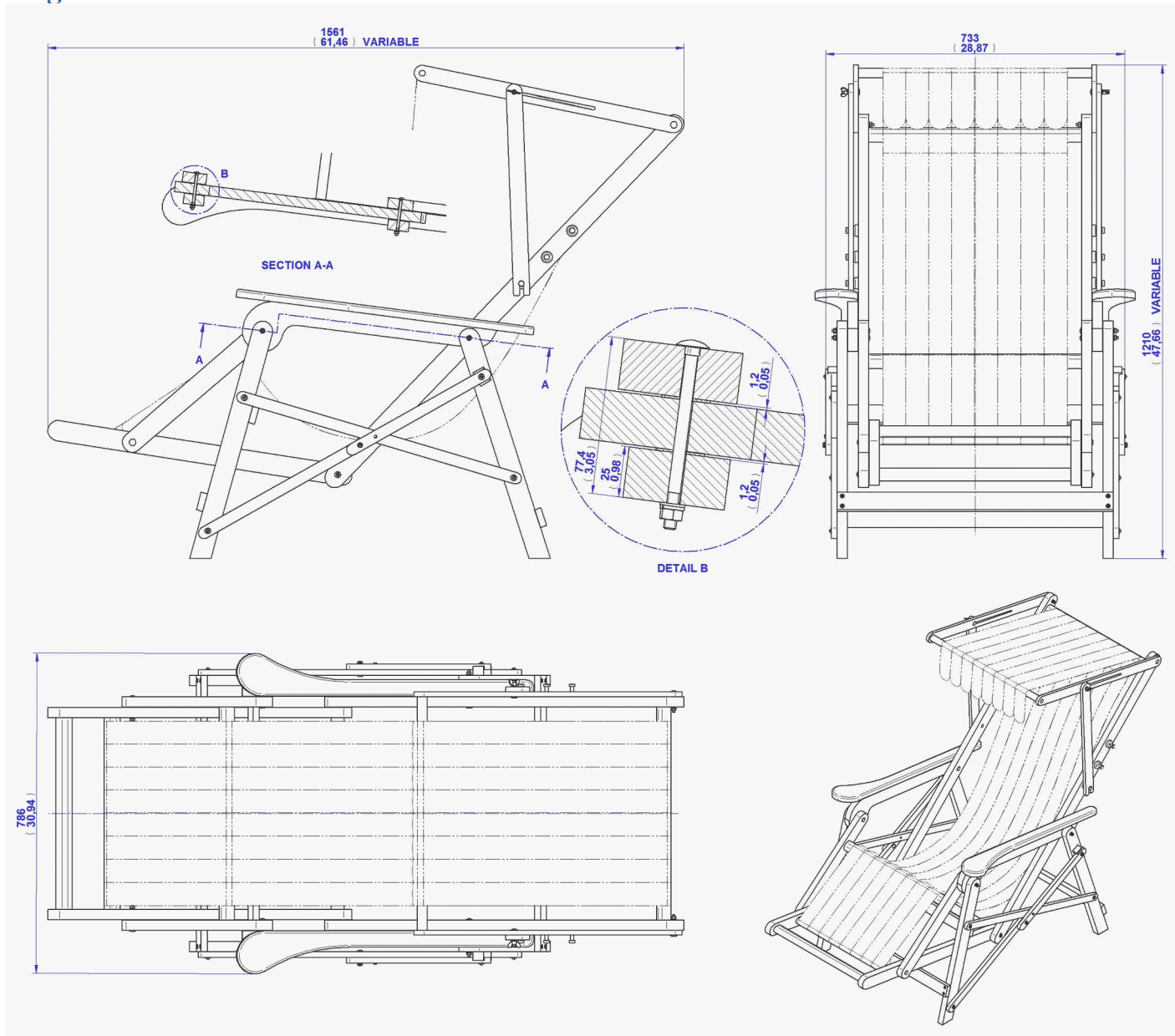

Main assembly standard parts

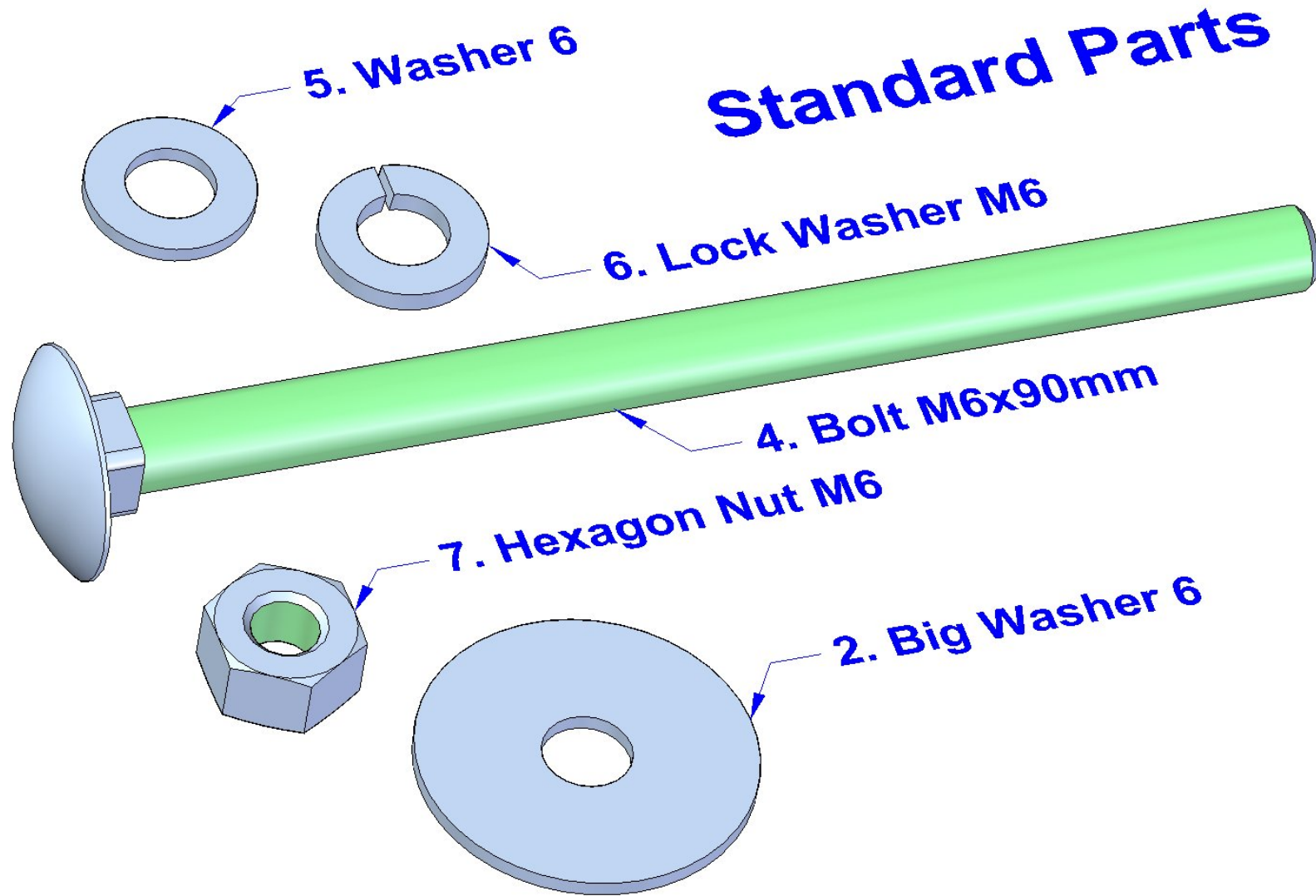

Stationary sub-assembly parts list

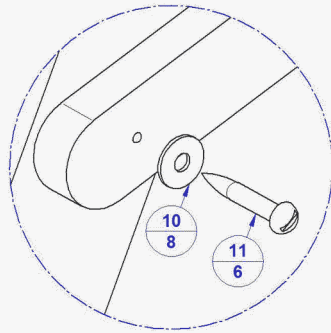

DETAIL A

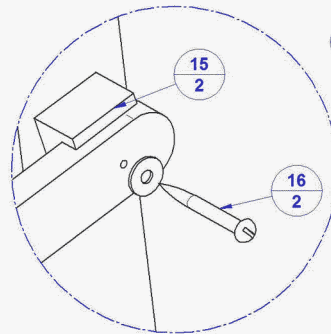

DETAIL B

Item Number	Title	Material	Quantity	Category
1	Arm Plank	Wood	2	
2	Front Leg	Wood	1	
3	Back Leg	Wood	1	
4	Leg Long Crossbar	Wood	2	
5	Leg Support Crossbar	Wood	2	
6	Leg Holder Crossbar	Wood	2	
7	Arm Support	Wood	1	
8	Dowel D7x31	Wood	10	
9	Big Washer 6	Steel	4	Standard Part
10	Washer 5	Steel	8	Standard Part
11	Wood Screw D5x35mm	Steel	6	Standard Part
12	Washer 6	Steel	2	Standard Part
13	Bolt M6x35mm	Steel	2	Standard Part
14	Lock washer M6	Steel	2	Standard Part
15	Distancer	Wood	2	
16	Wood Screw D5x50mm	Steel	2	Standard Part
17	Hexagon nut M6 - Thin	Steel	2	Standard Part
18	Stationary Horizontal Lath	Wood	3	
19	Wood Screw D5x50mm	Steel	12	Standard Part
20	Arm Support Mirror	Wood	1	
21	Front Leg Mirror	Wood	1	
22	Back Leg Mirror	Wood	1	

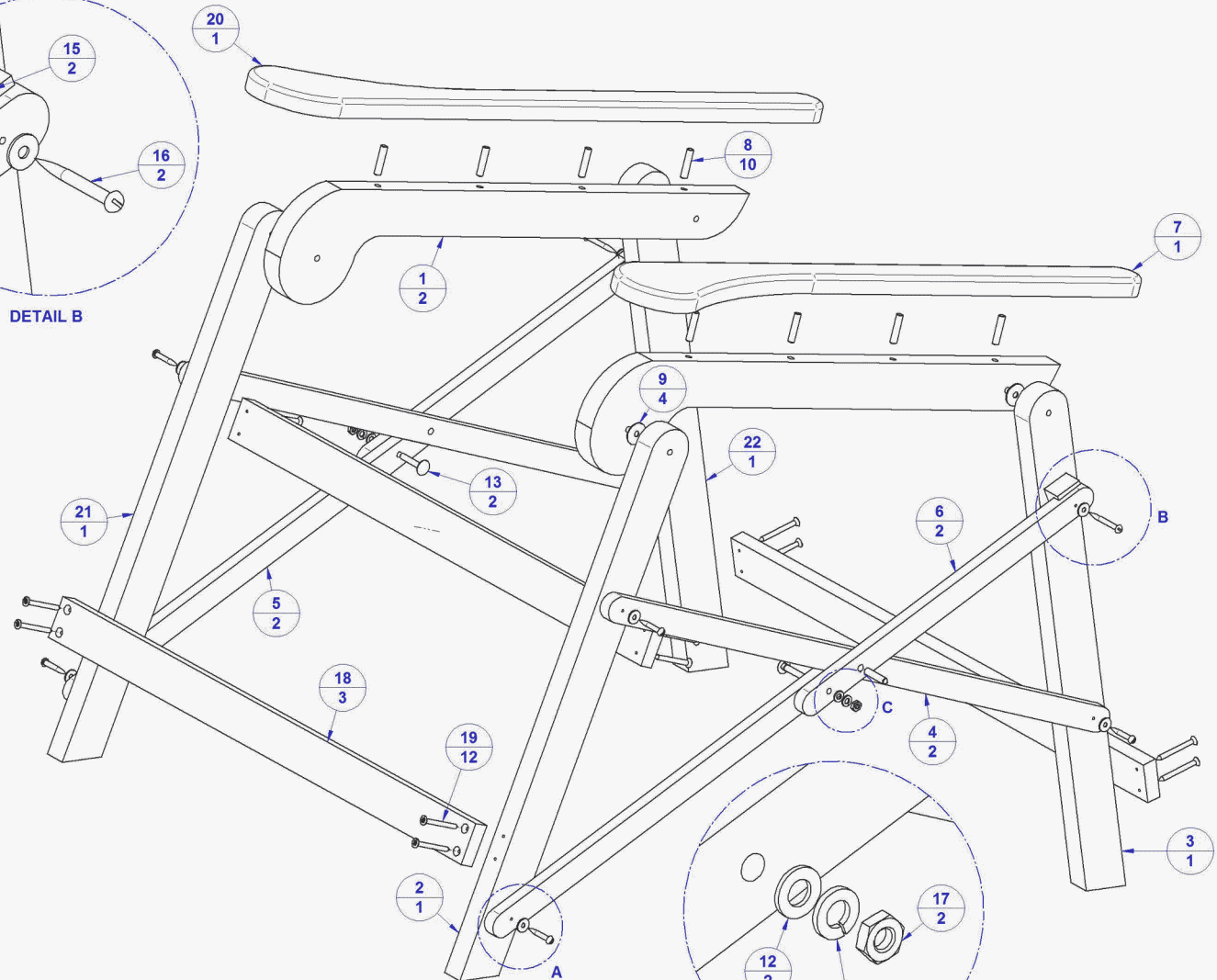

DETAIL C

Stationary sub-assembly drawing

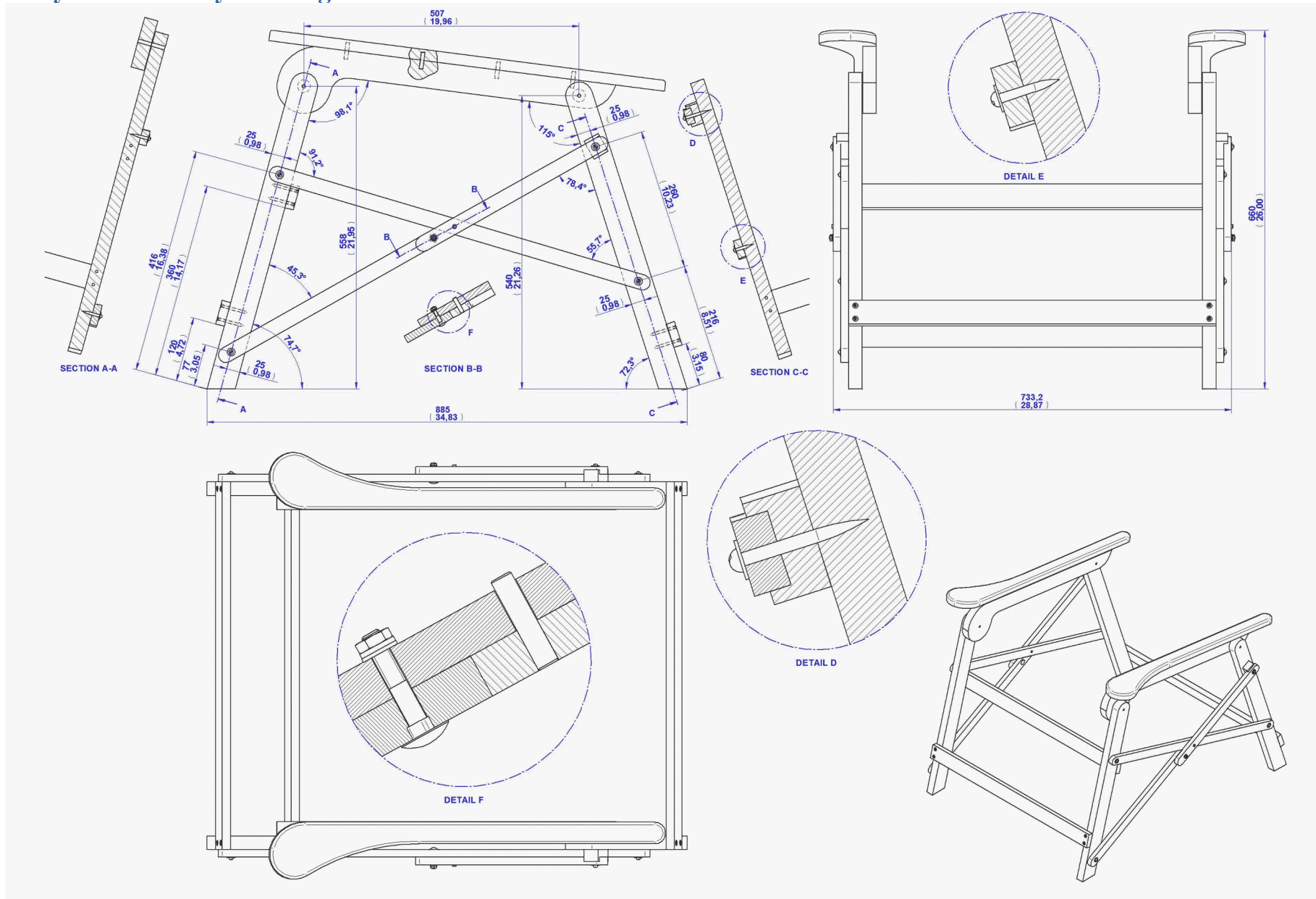

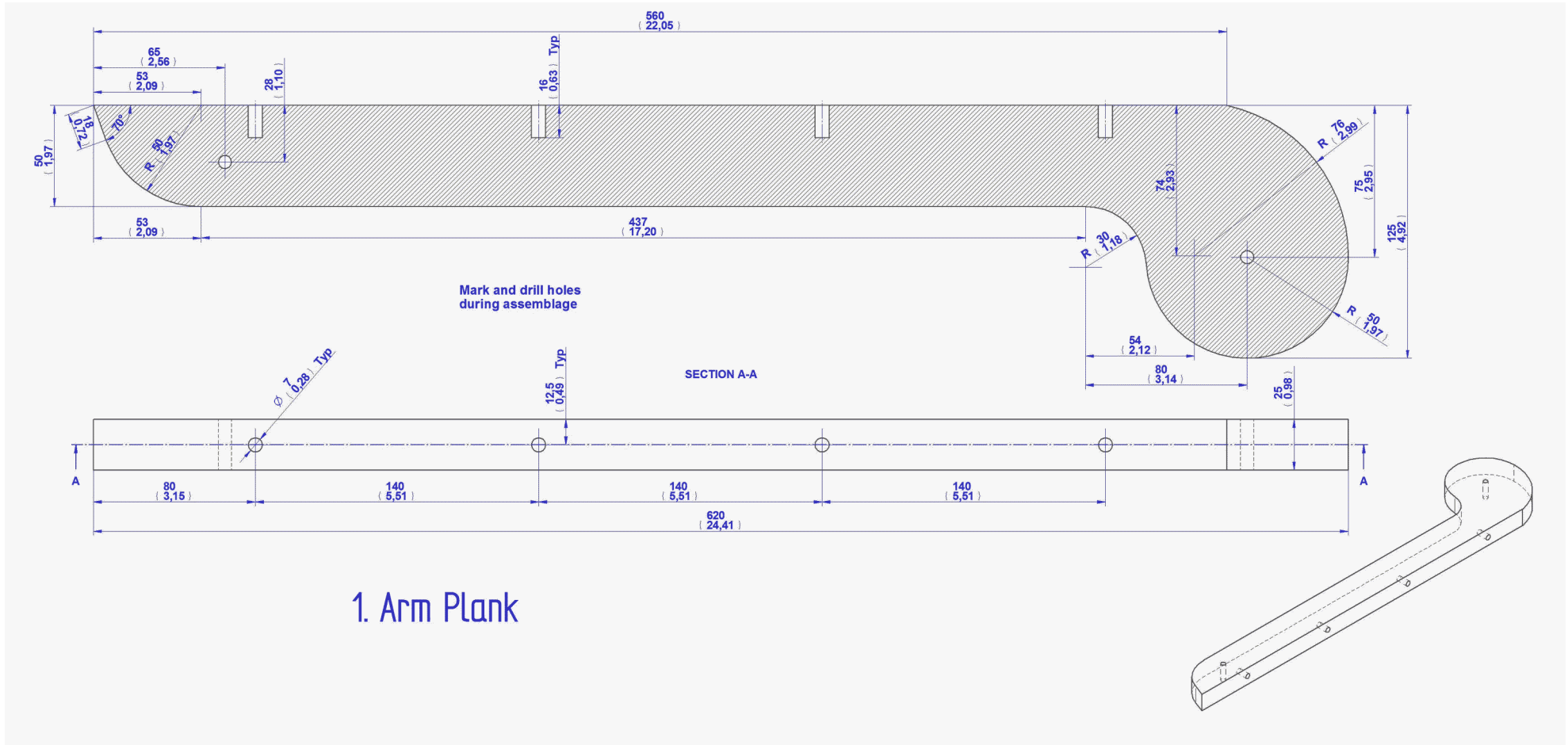

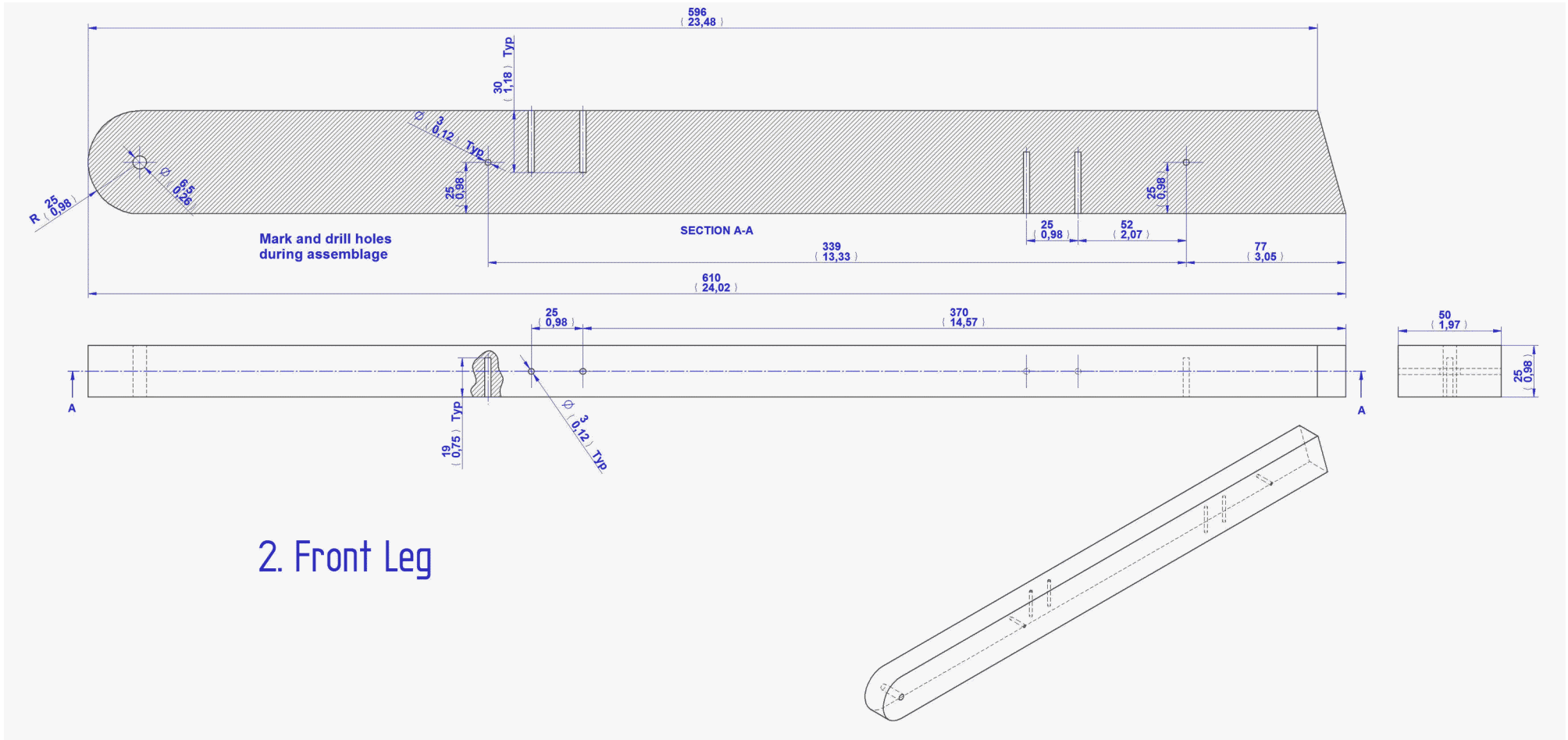

2. Front Leg

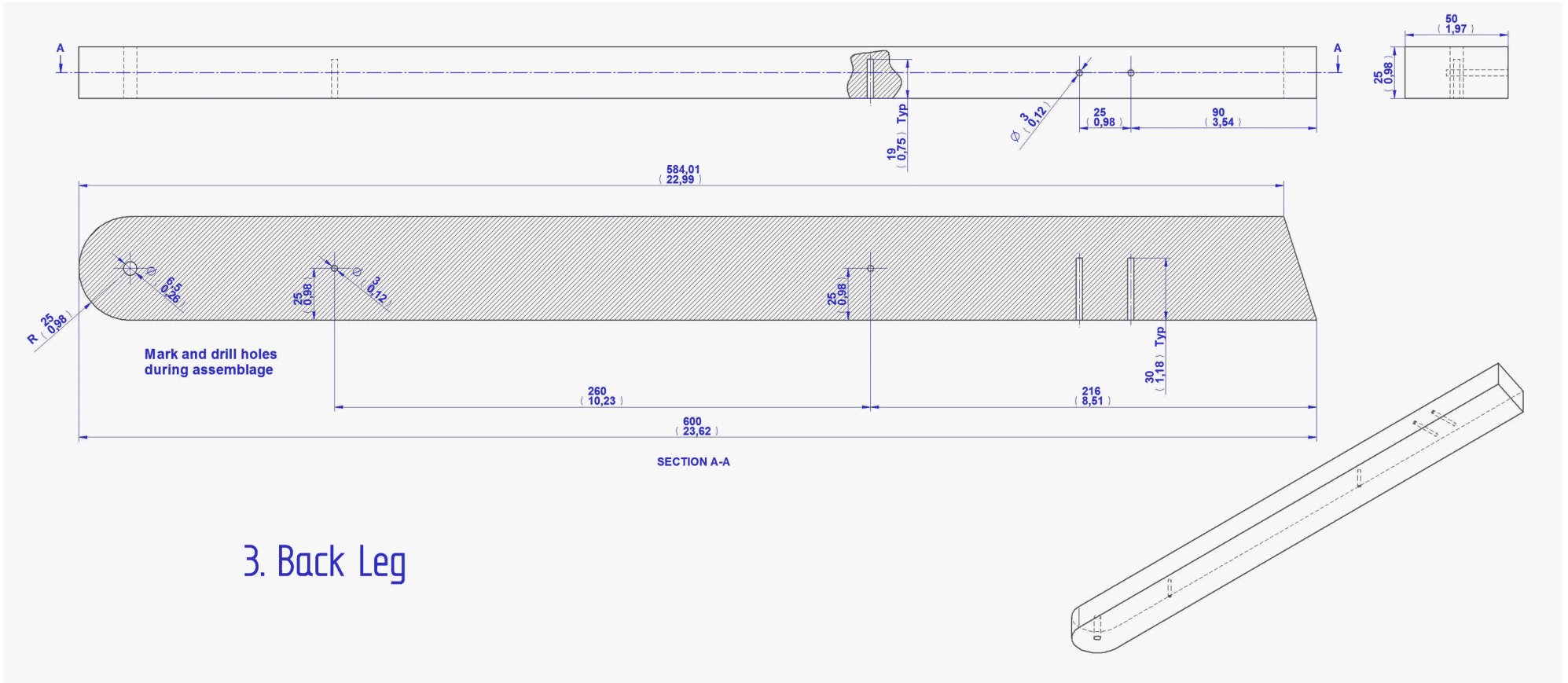

3. Back Leg

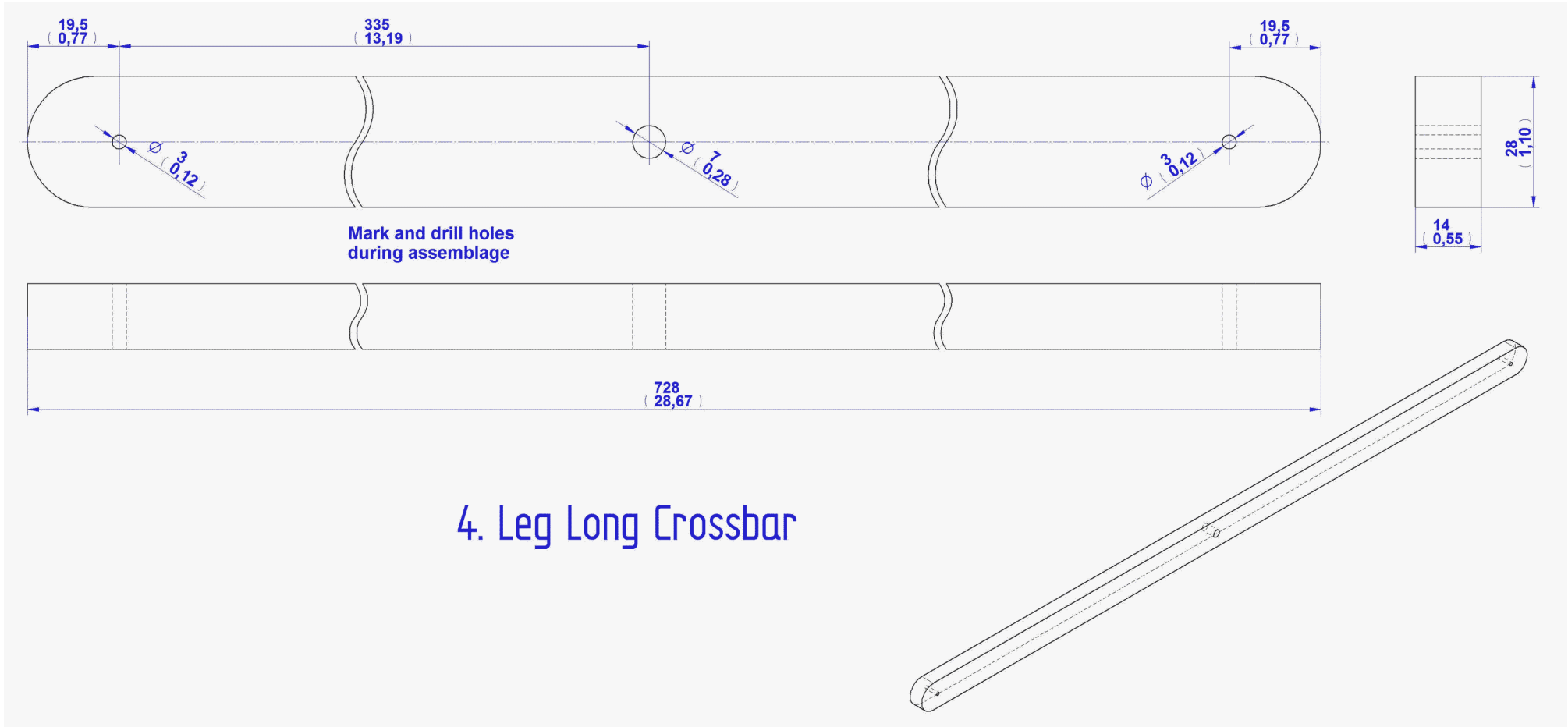

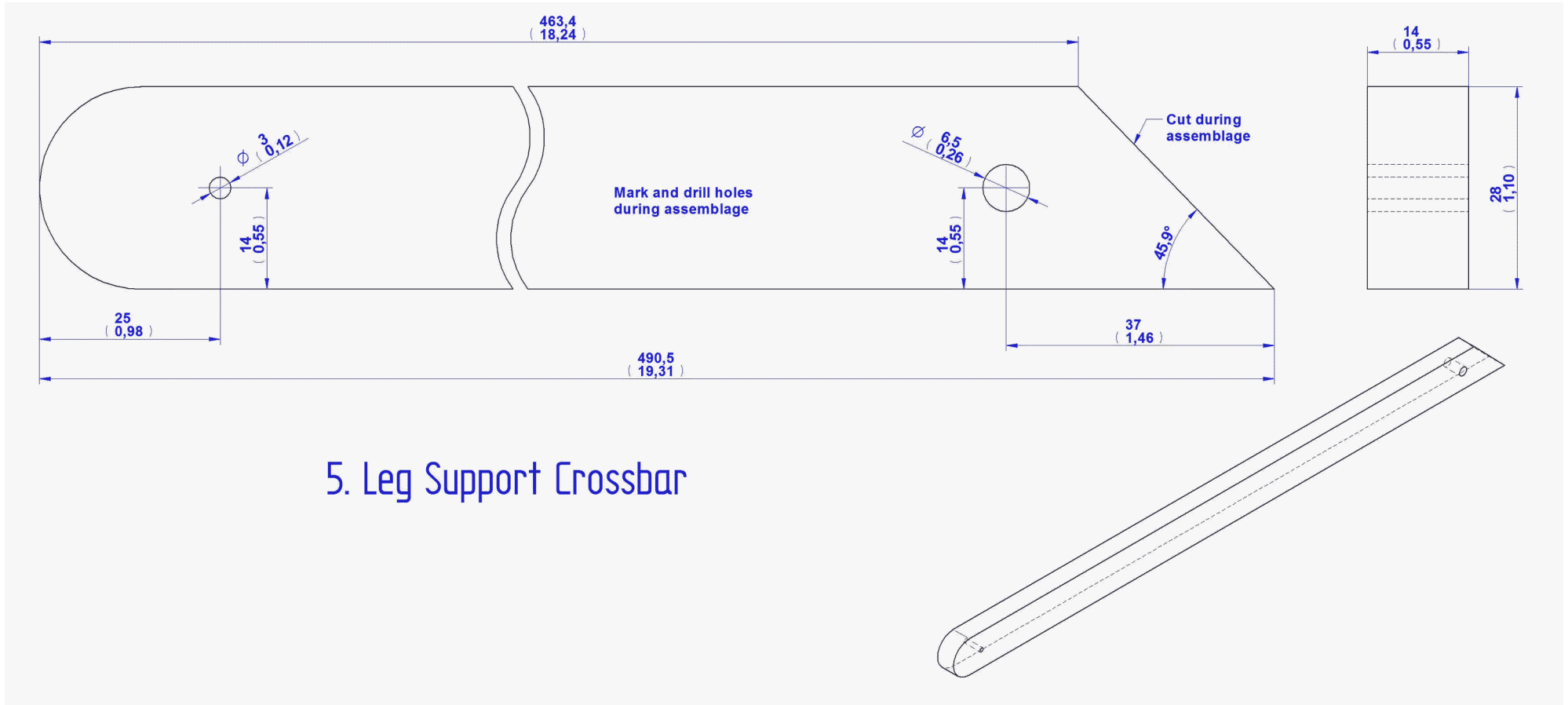

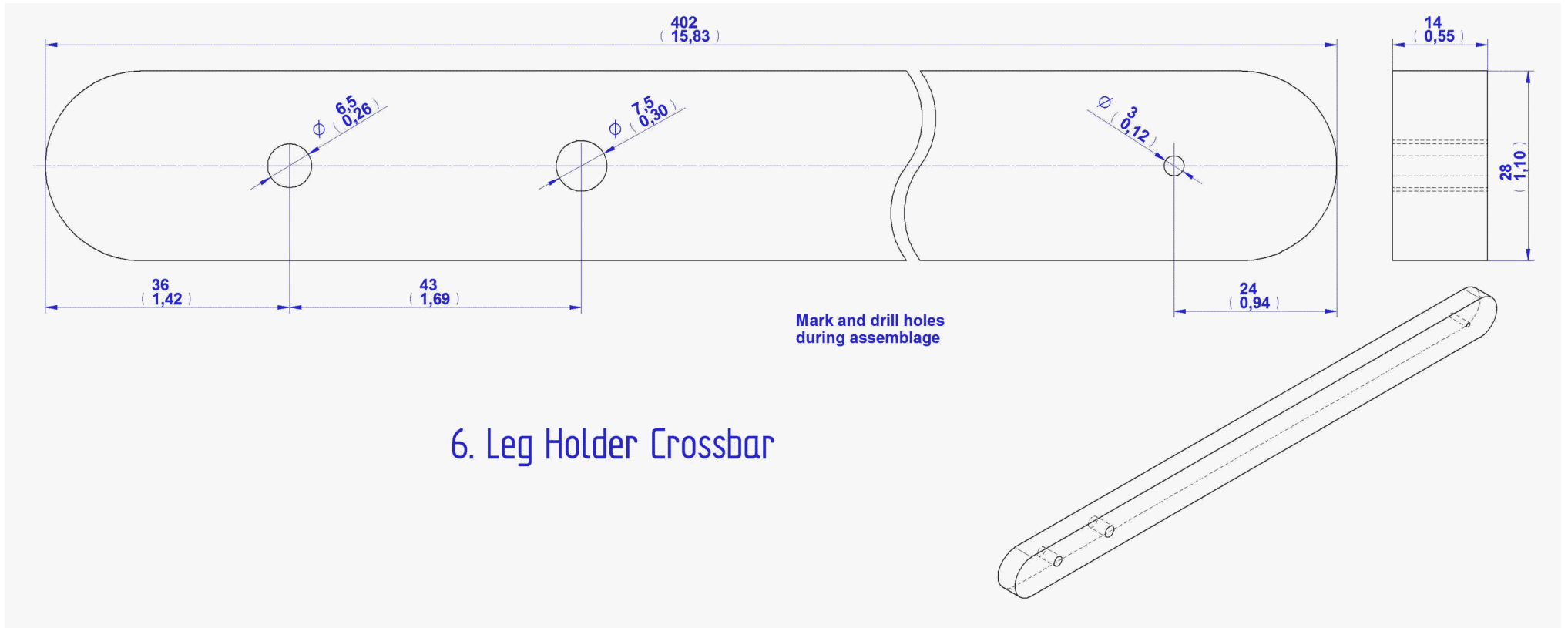

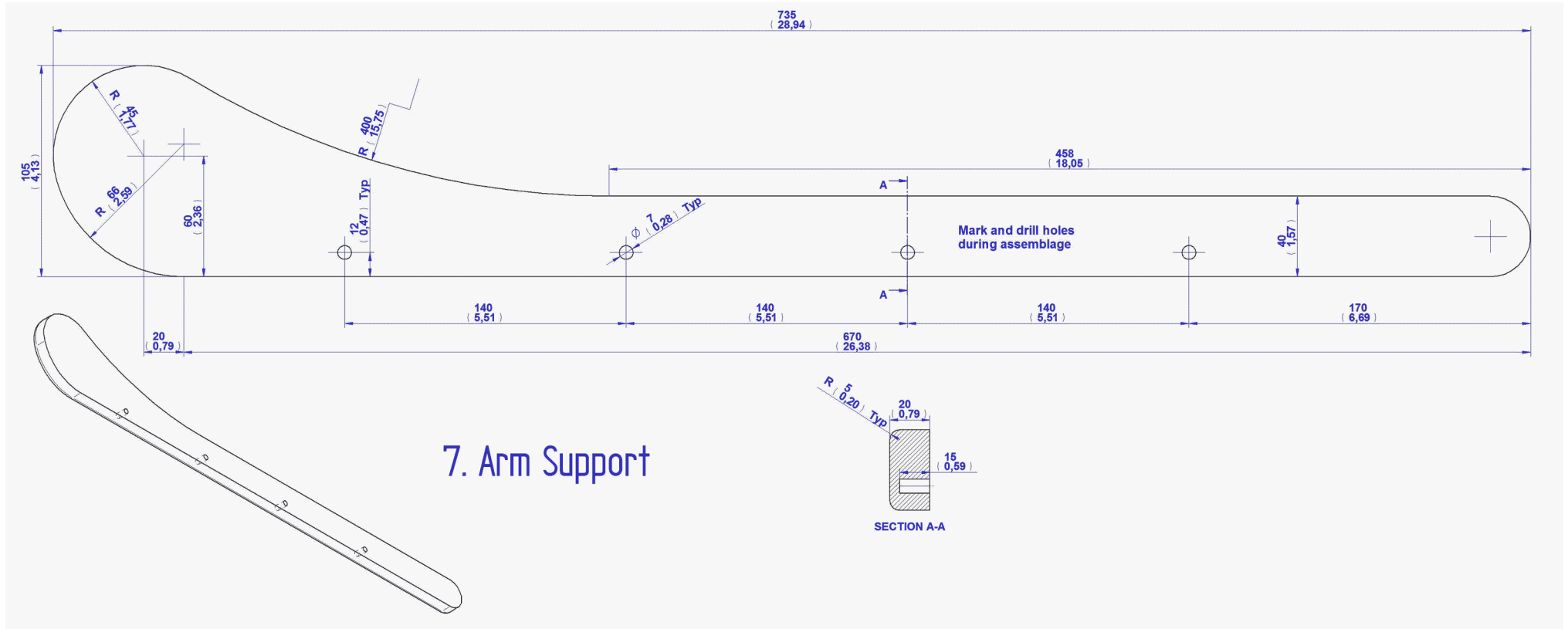

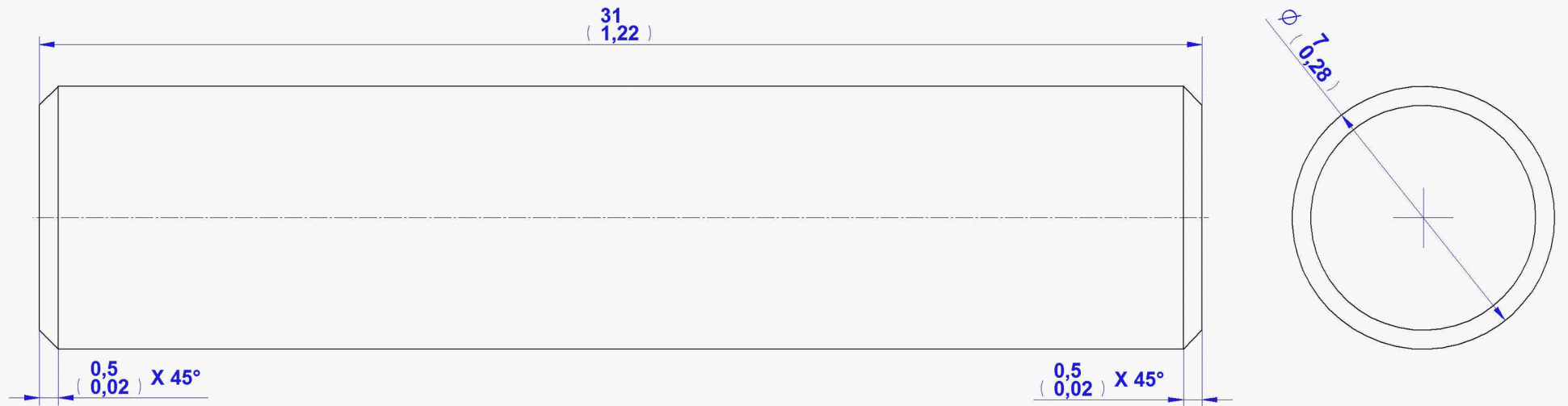

8. Dowel D7 x 31mm

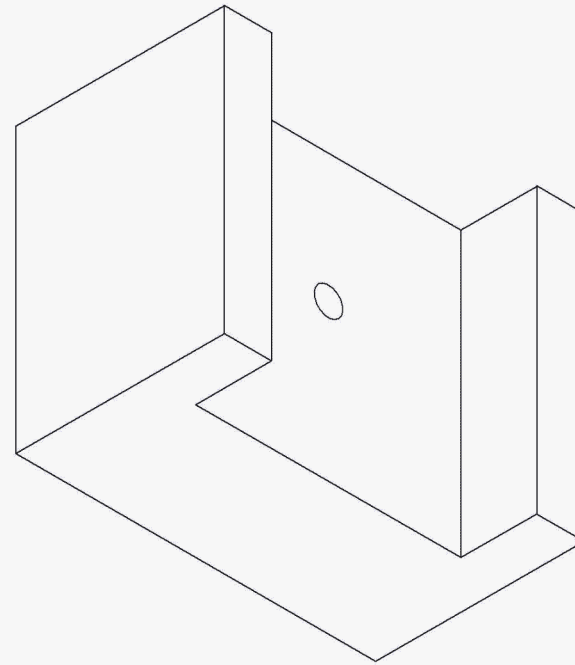
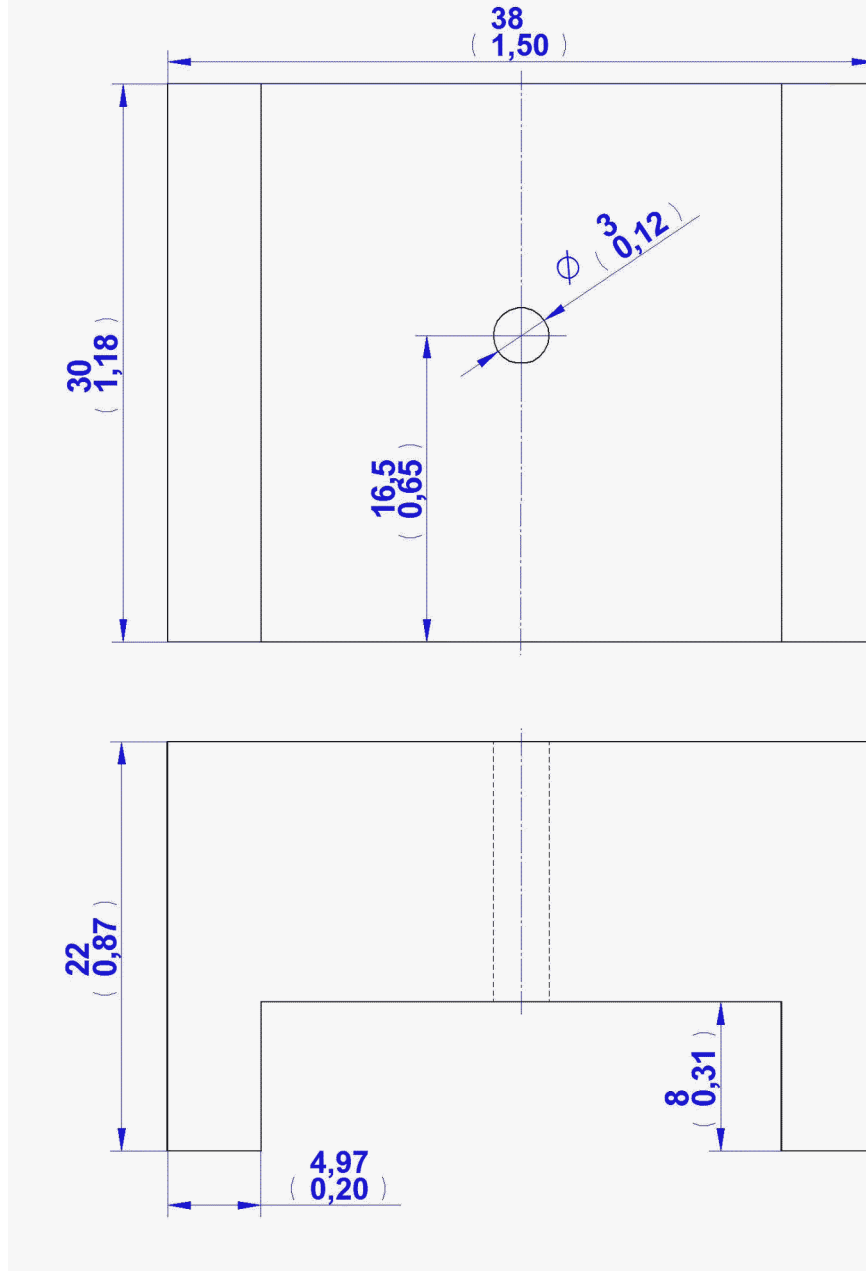

15. Distancer

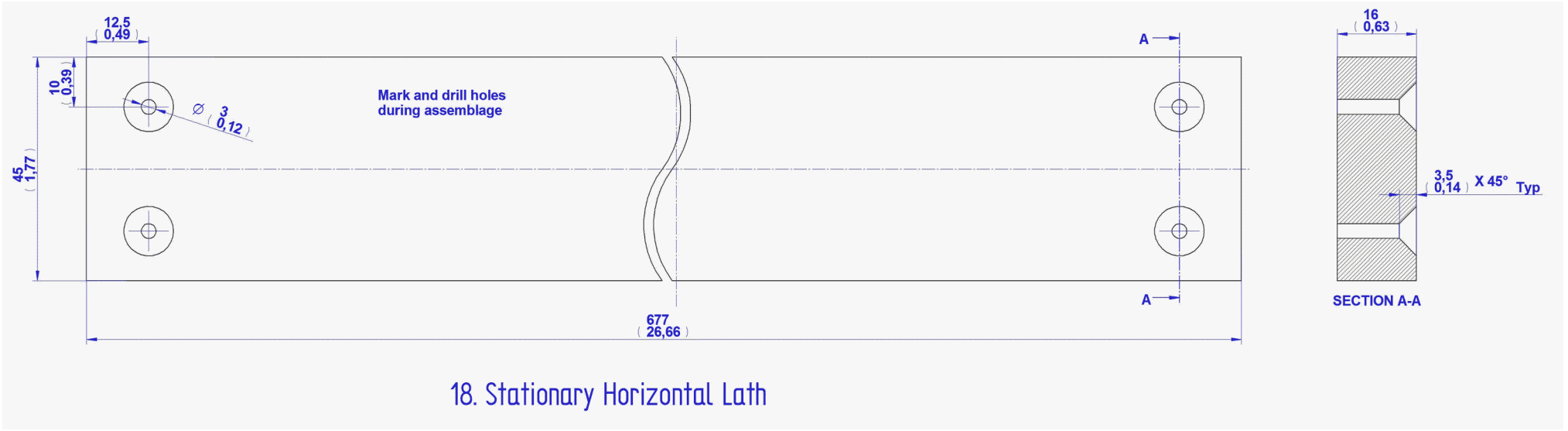

Mirror Parts

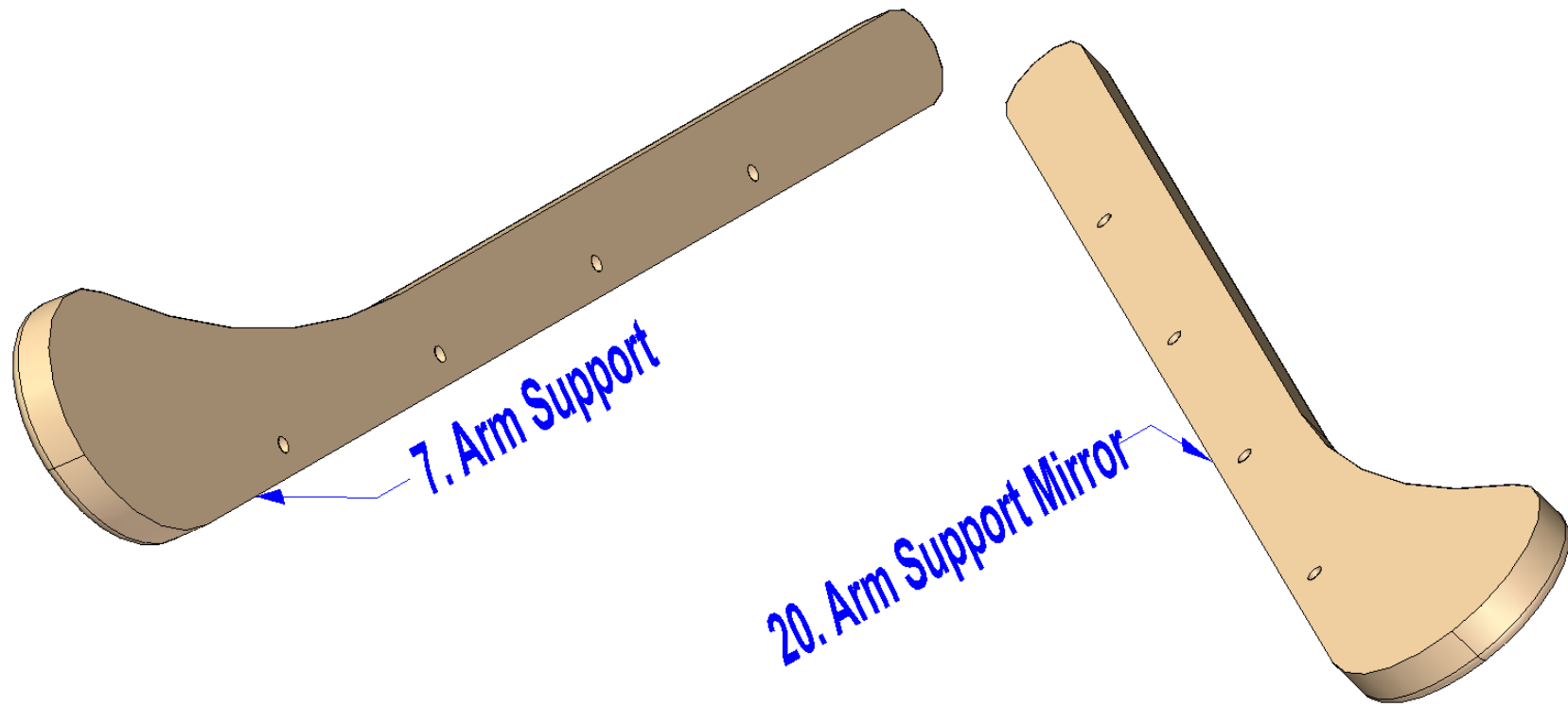

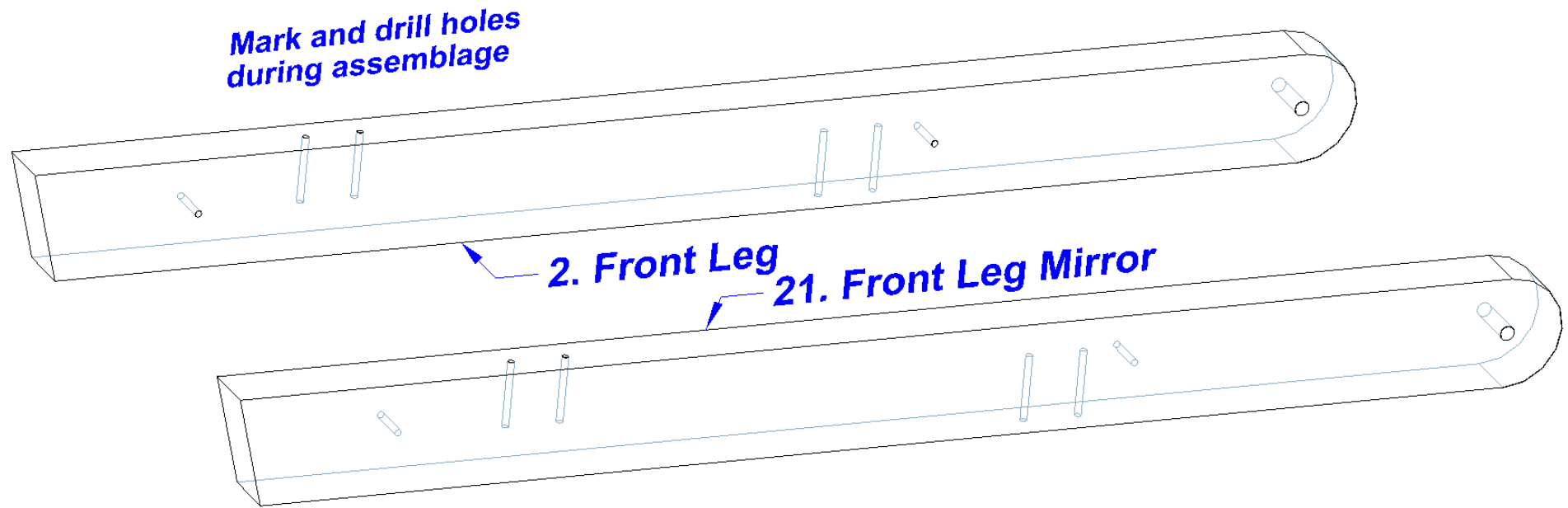

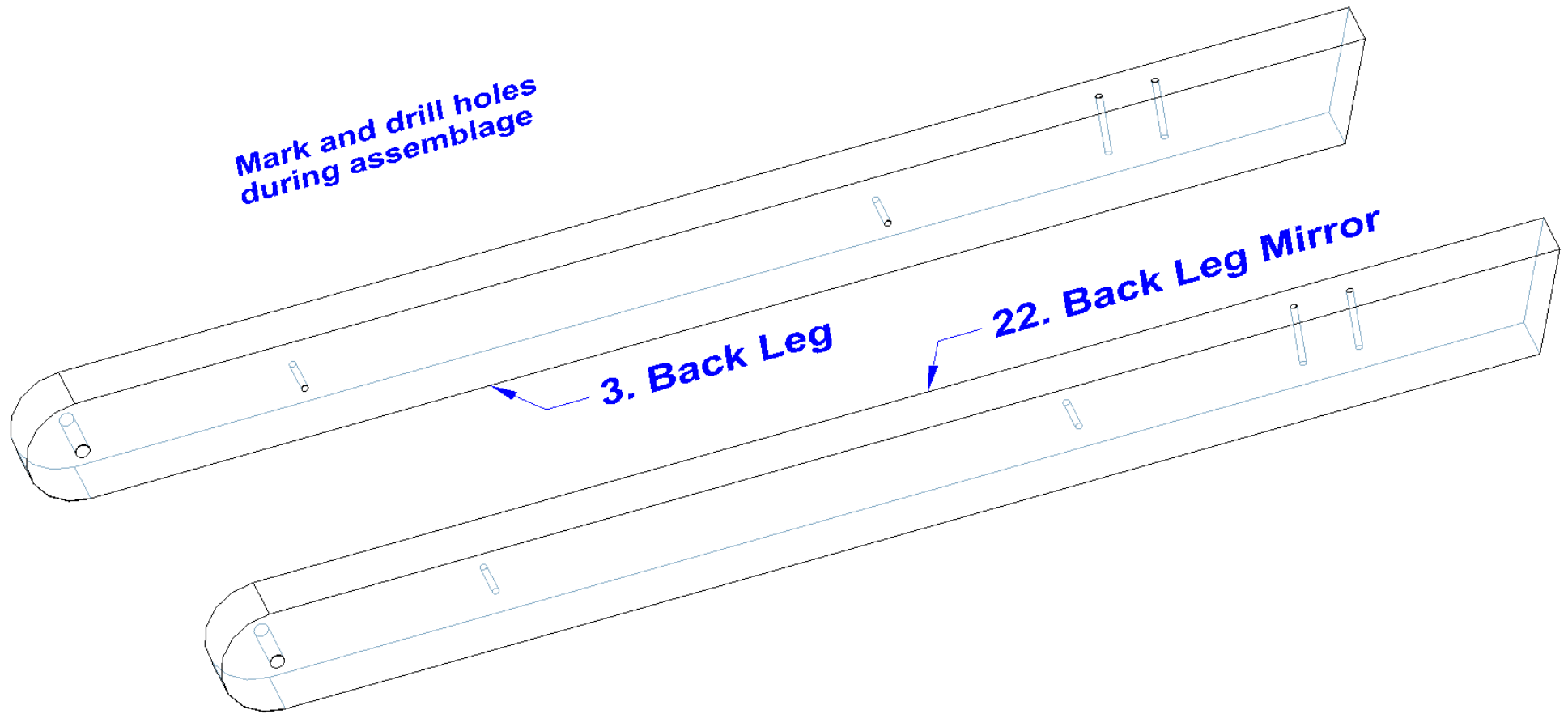

Standard Parts

Standard Parts



Stationary sub-assembly - Assemblage images

1.

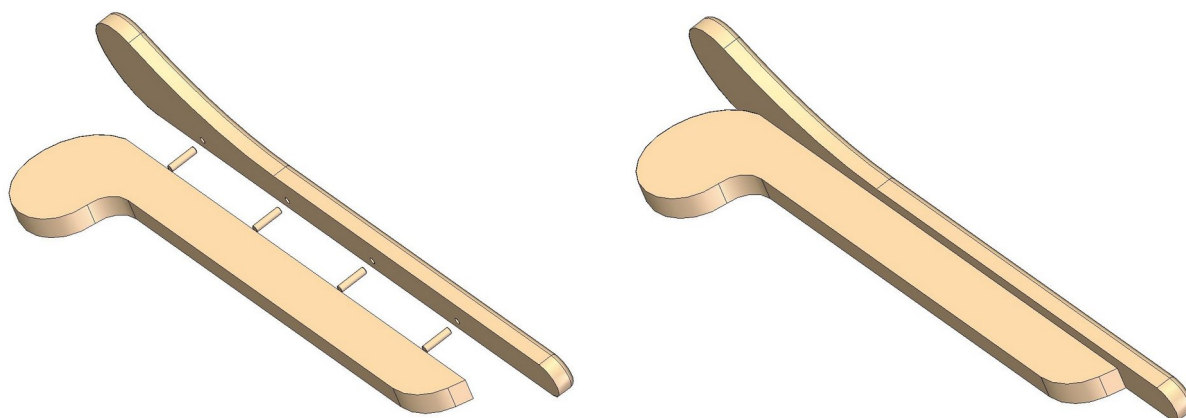

2.

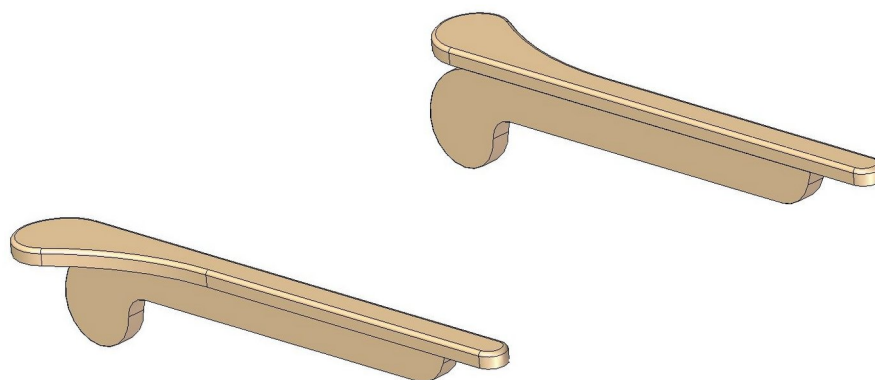

3.

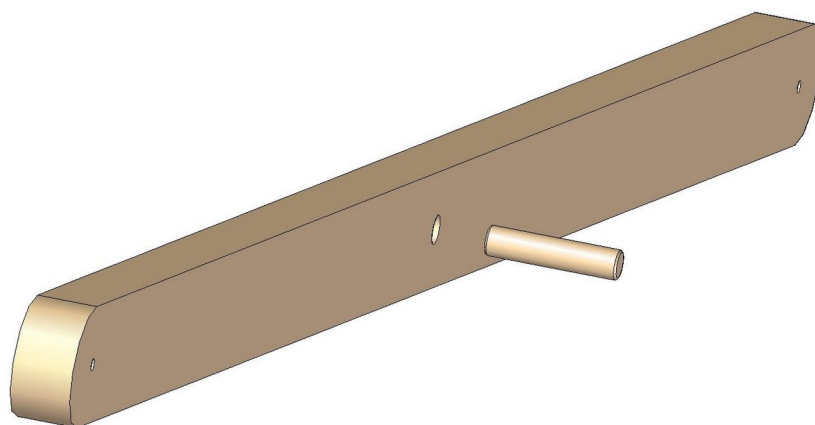

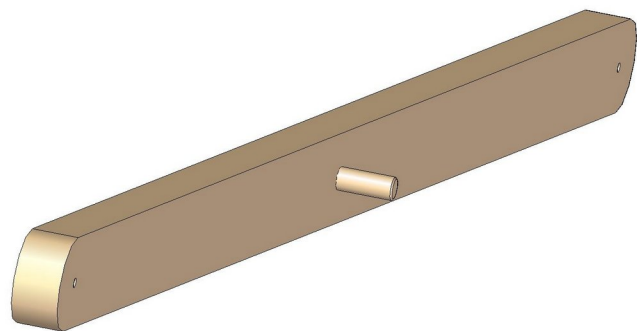

4.

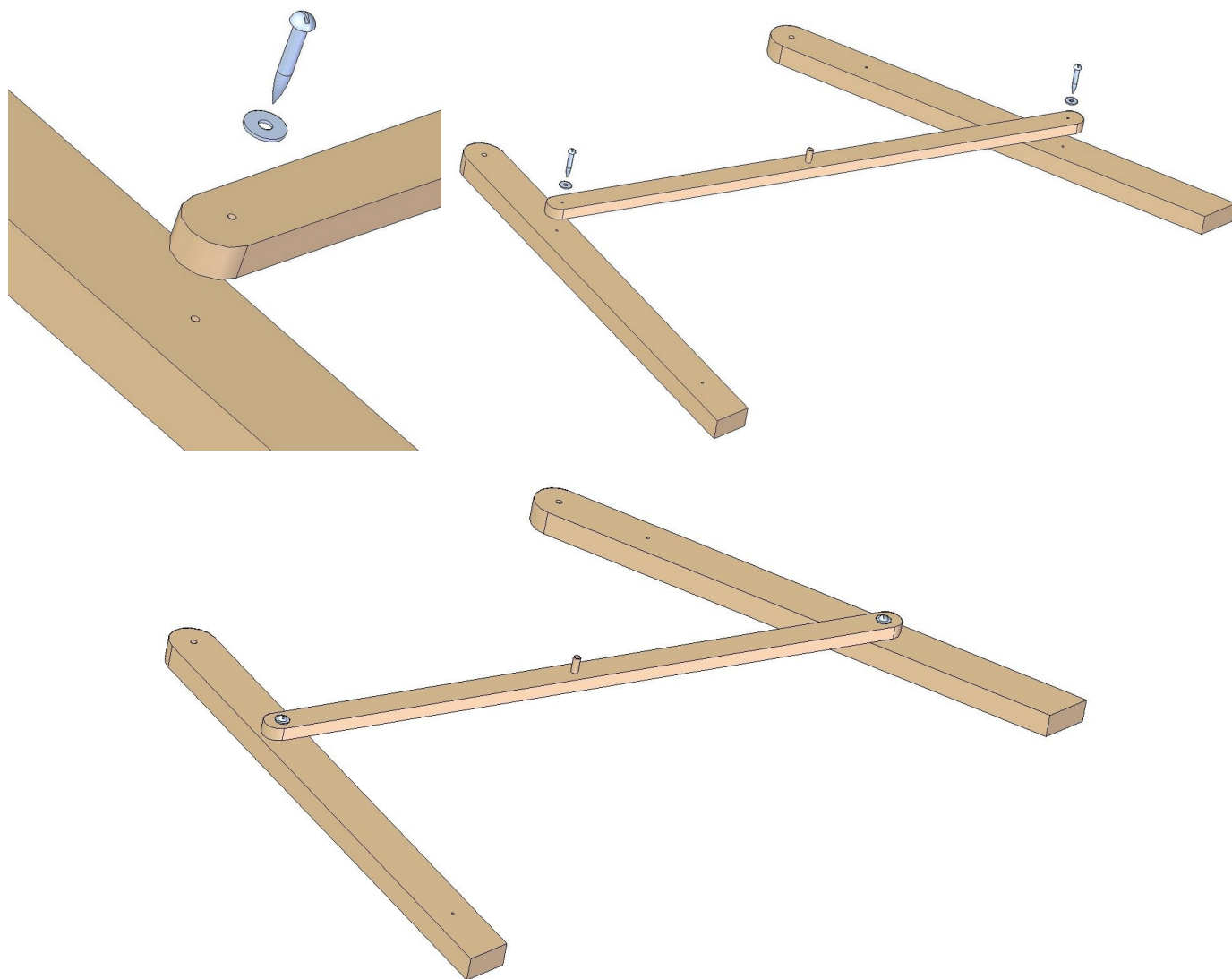

5.

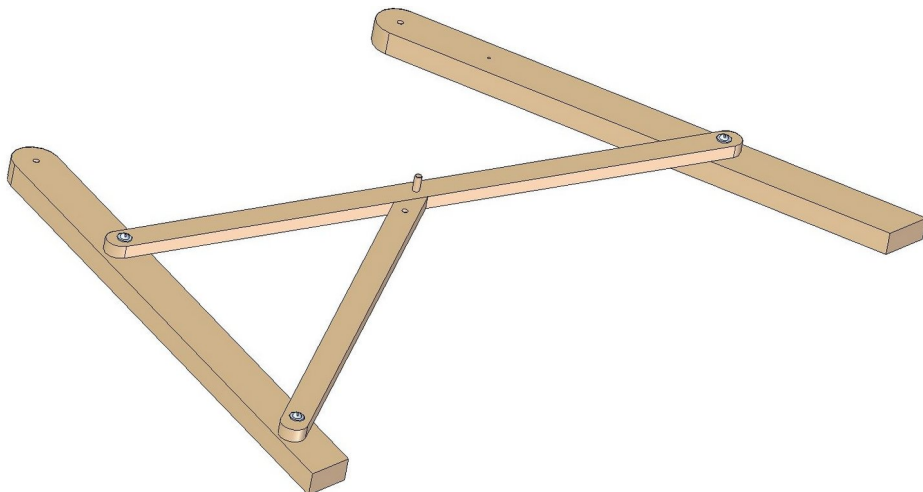
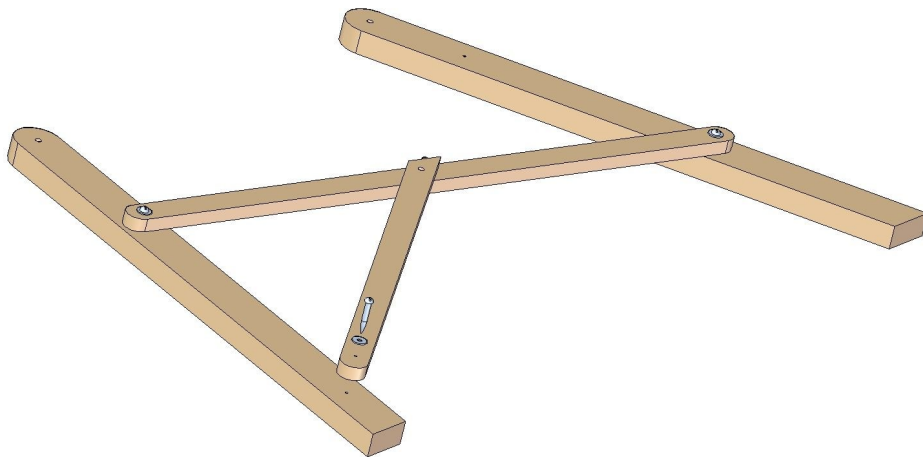
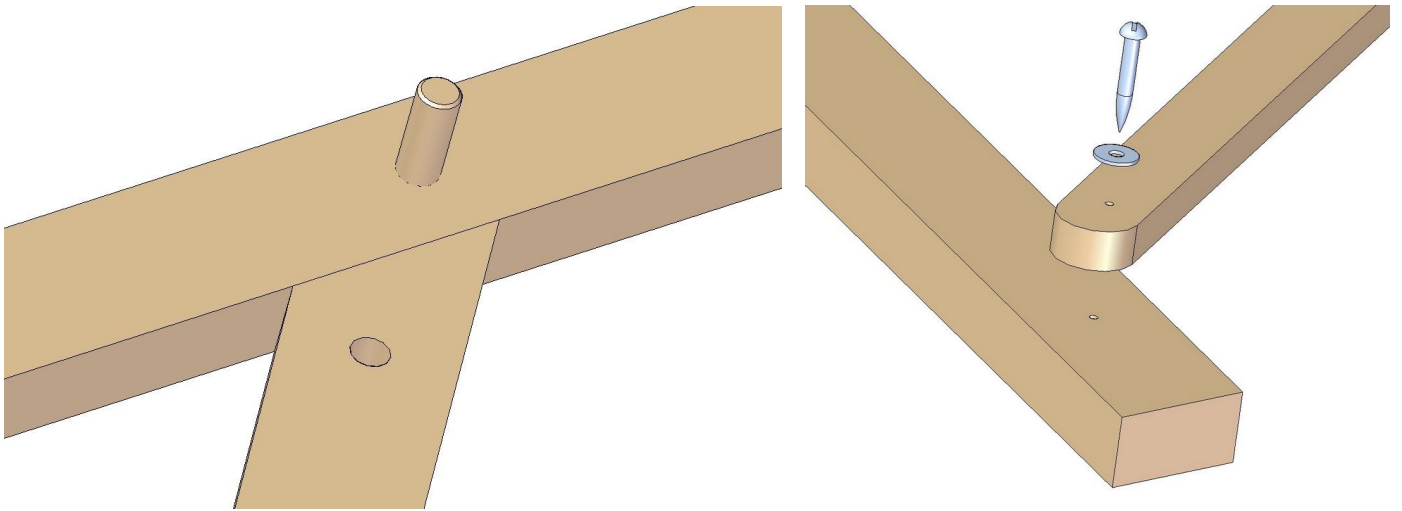

6.

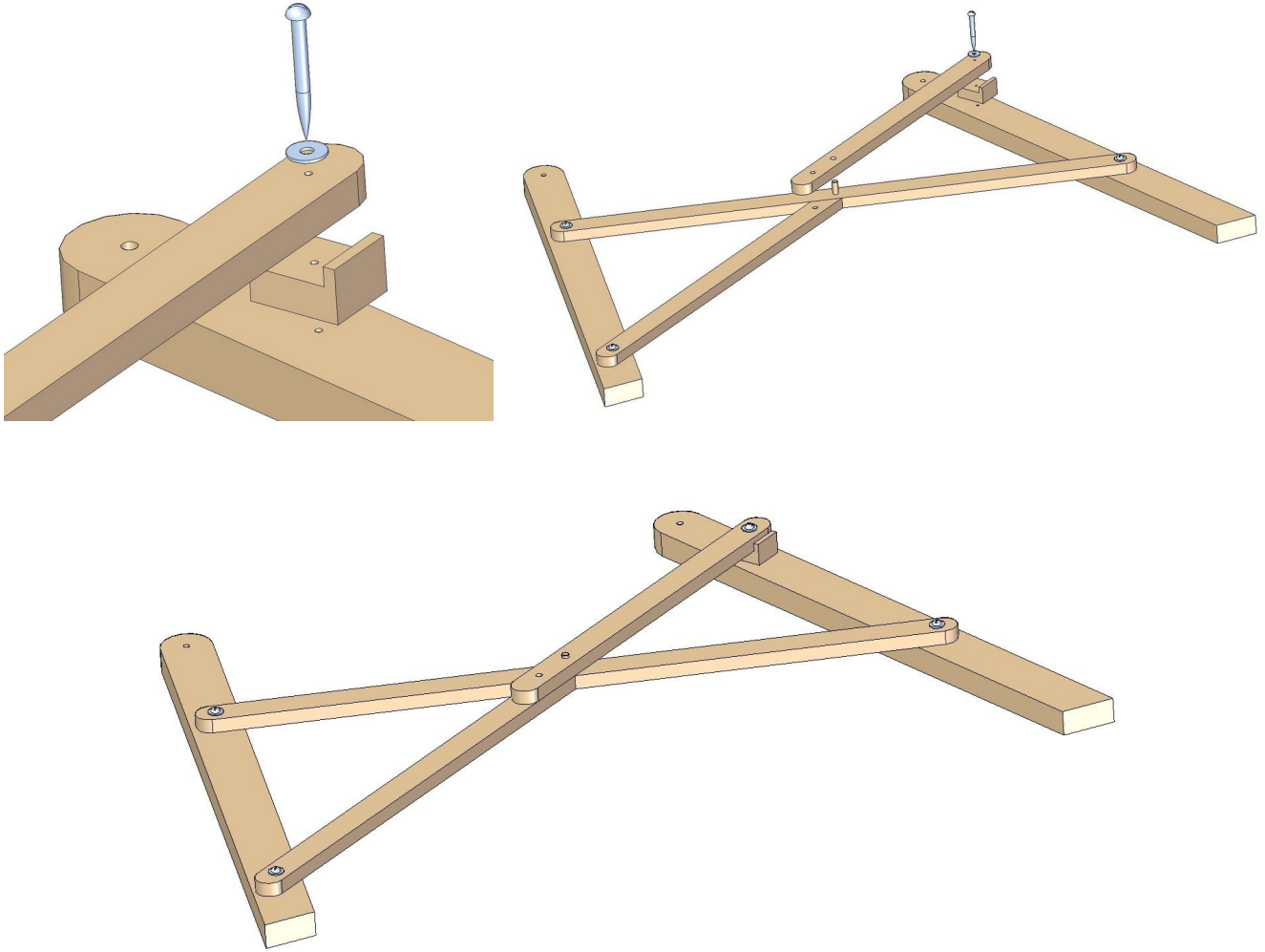

7.

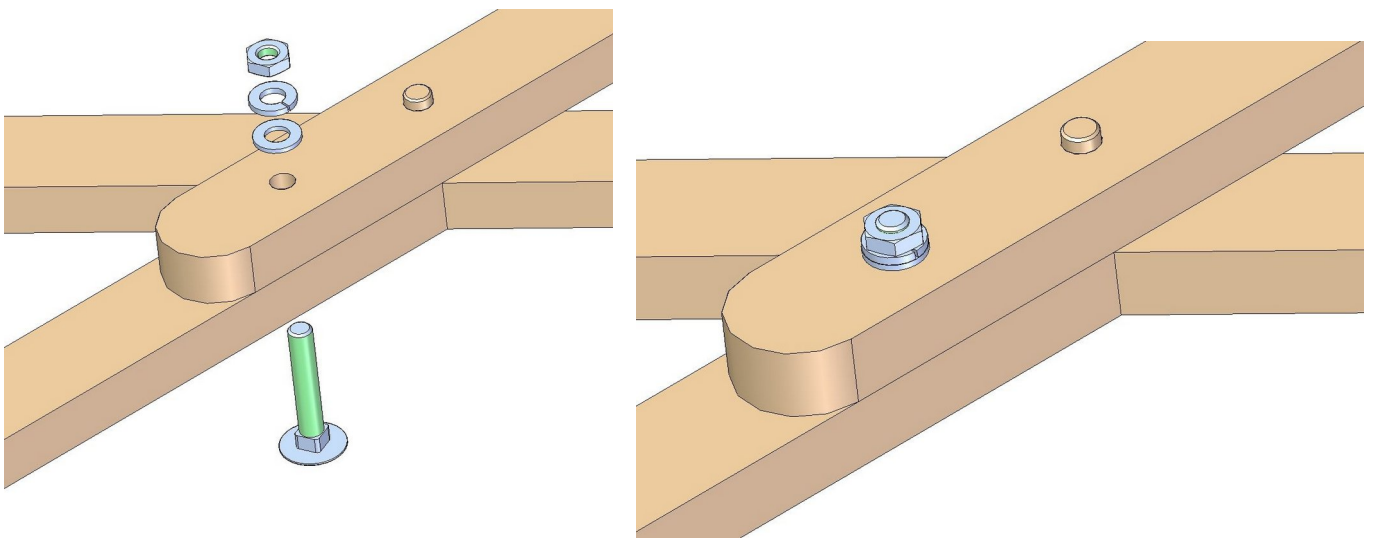

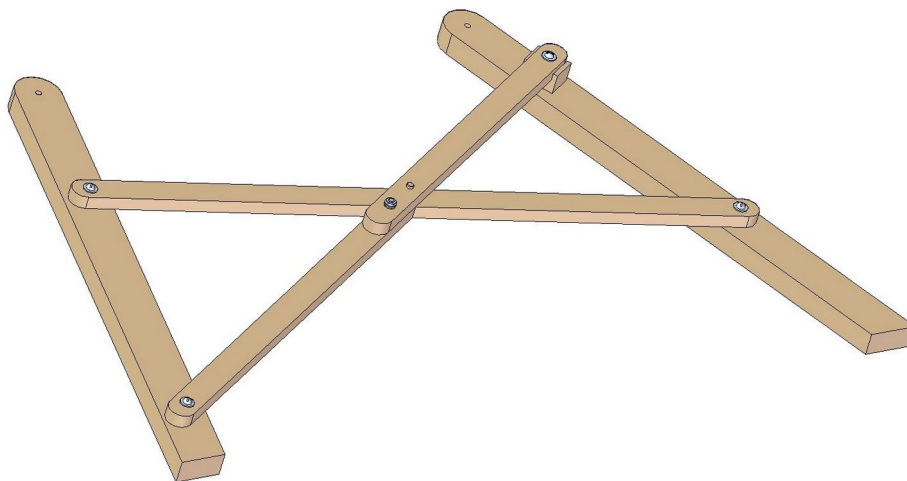

8.

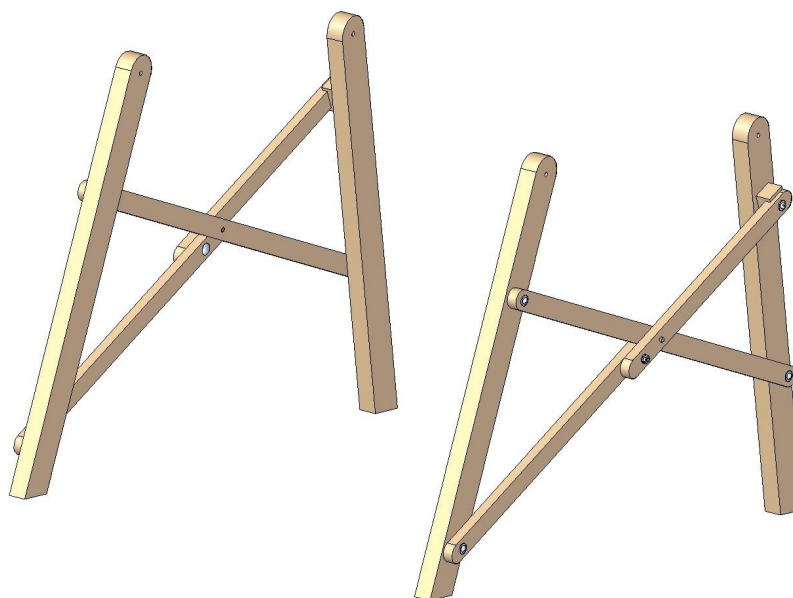

9.

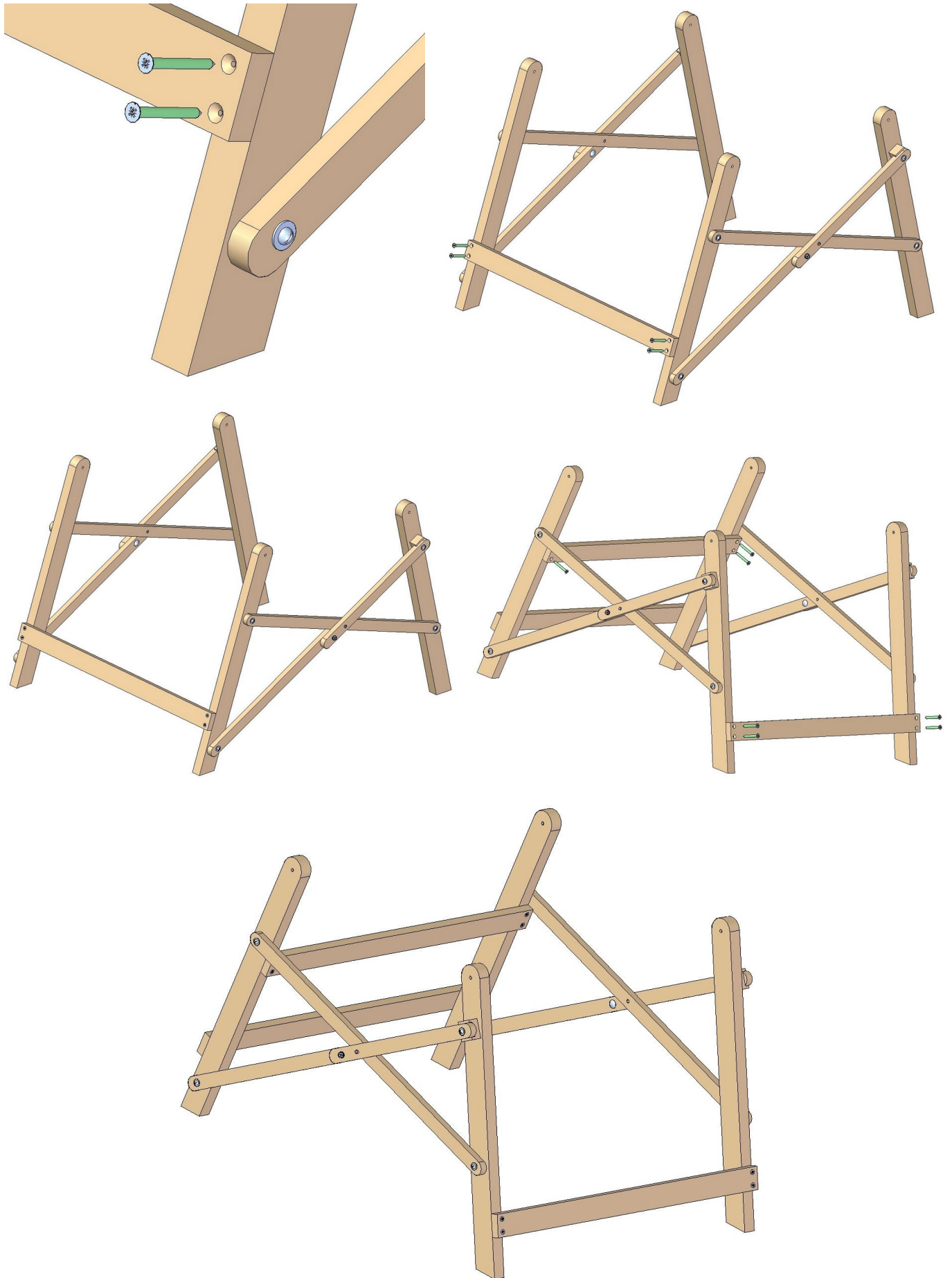

Movable sub-assembly parts list

Item Number	Title	Material	Quantity	Category
1	Movable Lath	Wood	2	
2	Lower Movable Horizontal Lath	Wood	2	
3	Rounded Movable Horizontal Lath	Wood	1	
4	Back Rotational Lath	Wood	2	
5	Washer 5	Steel	2	Standard Part
6	Wood Screw D5x60mm	Steel	2	Standard Part
7	Front Rotational Lath	Wood	2	
8	Upper Movable Horizontal Lath	Wood	2	
9	Big Washer 6	Steel	4	Standard Part
10	Bolt M6x60mm	Steel	2	Standard Part
11	Washer 6	Steel	6	Standard Part
12	Lock washer M6	Steel	6	Standard Part
13	Hexagon Nut M6	Steel	4	Standard Part
14	Upper Rotational Lath	Wood	2	
15	Holder Lath	Wood	2	
16	Small Support	Wood	6	
17	Bolt M6x40mm	Steel	2	Standard Part
18	Wing Nut M6	Steel	2	Standard Part
19	Top Horizontal Lath	Wood	1	
20	Bolt M6x50mm	Steel	2	Standard Part

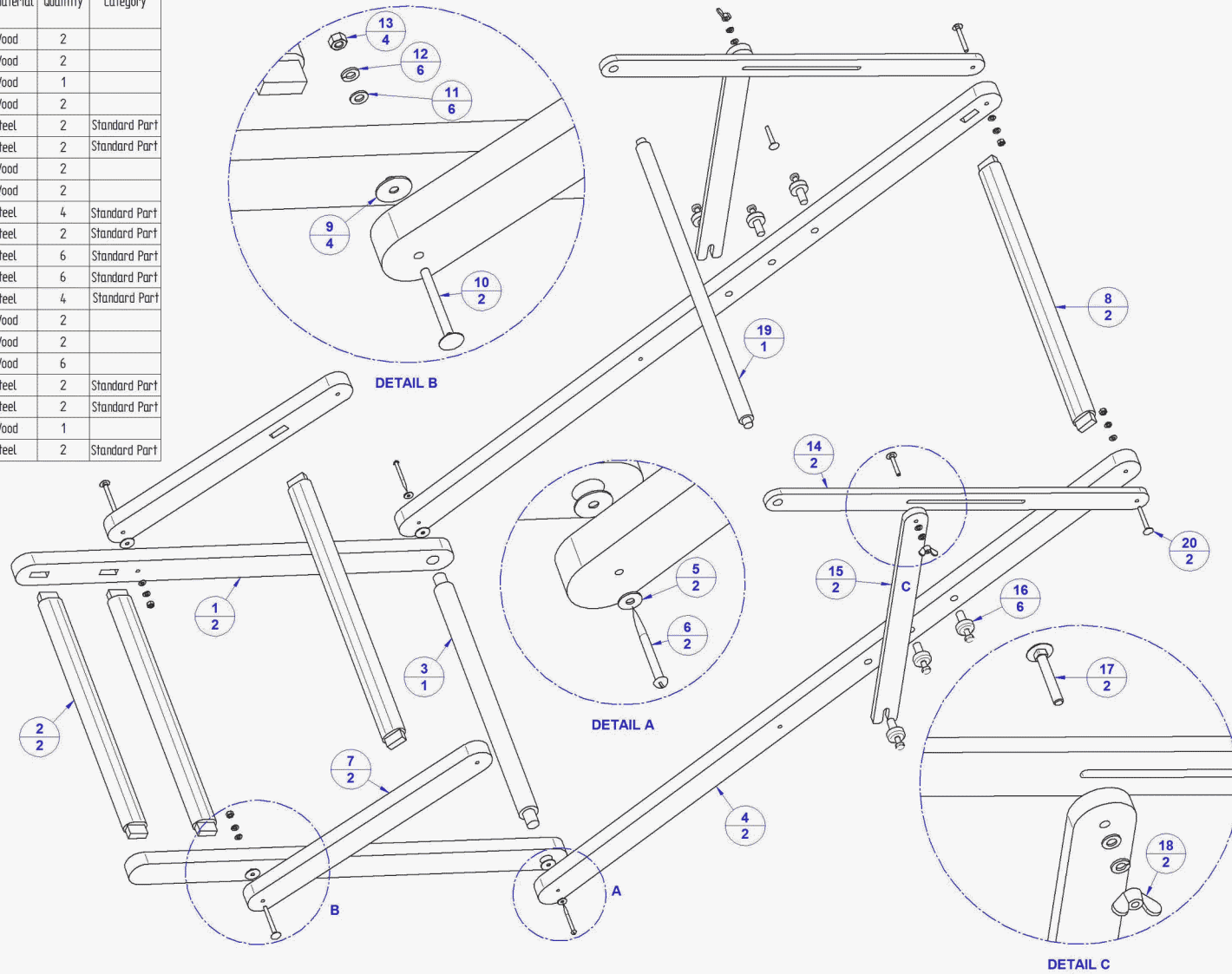

Movable sub-assembly drawing

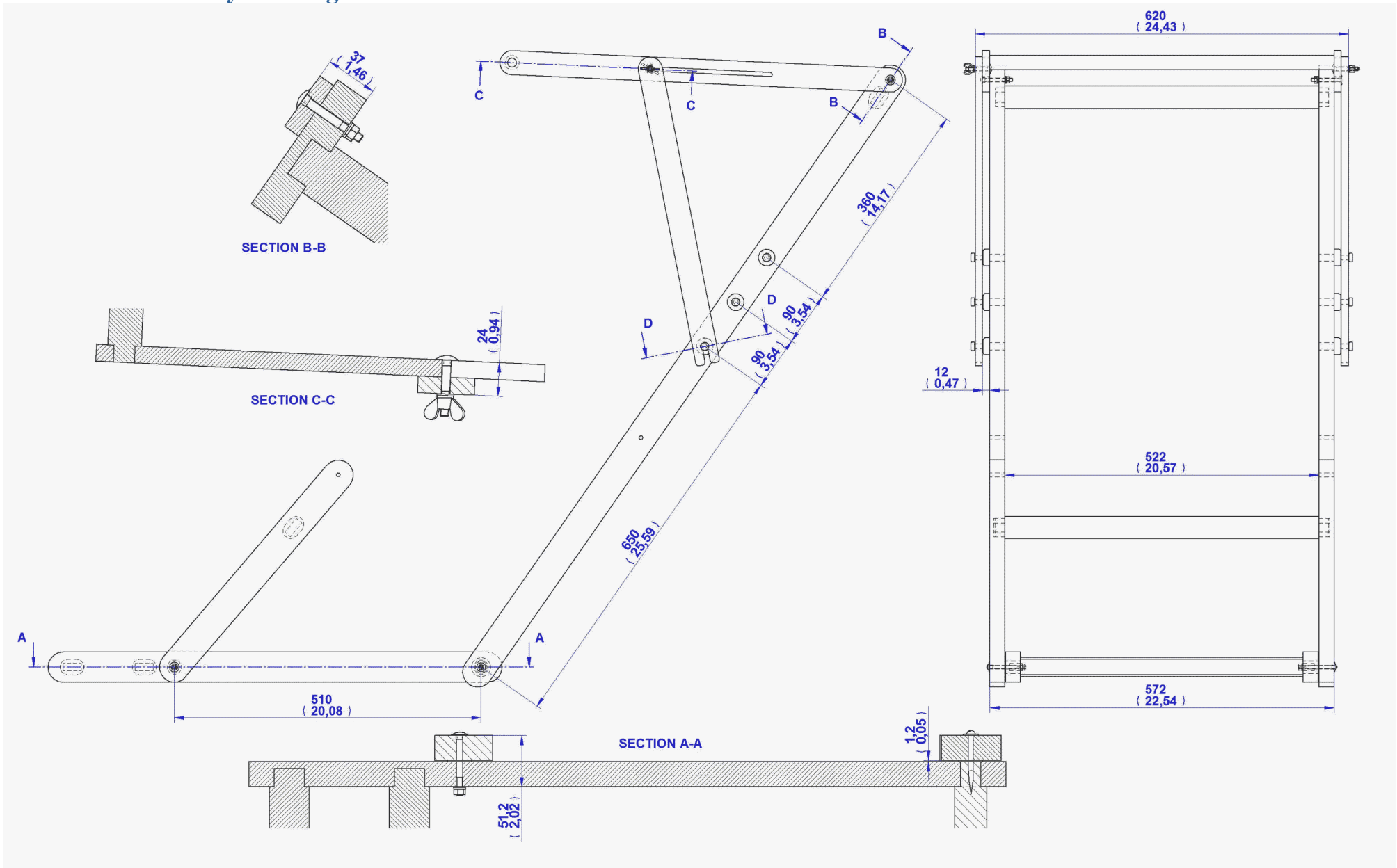

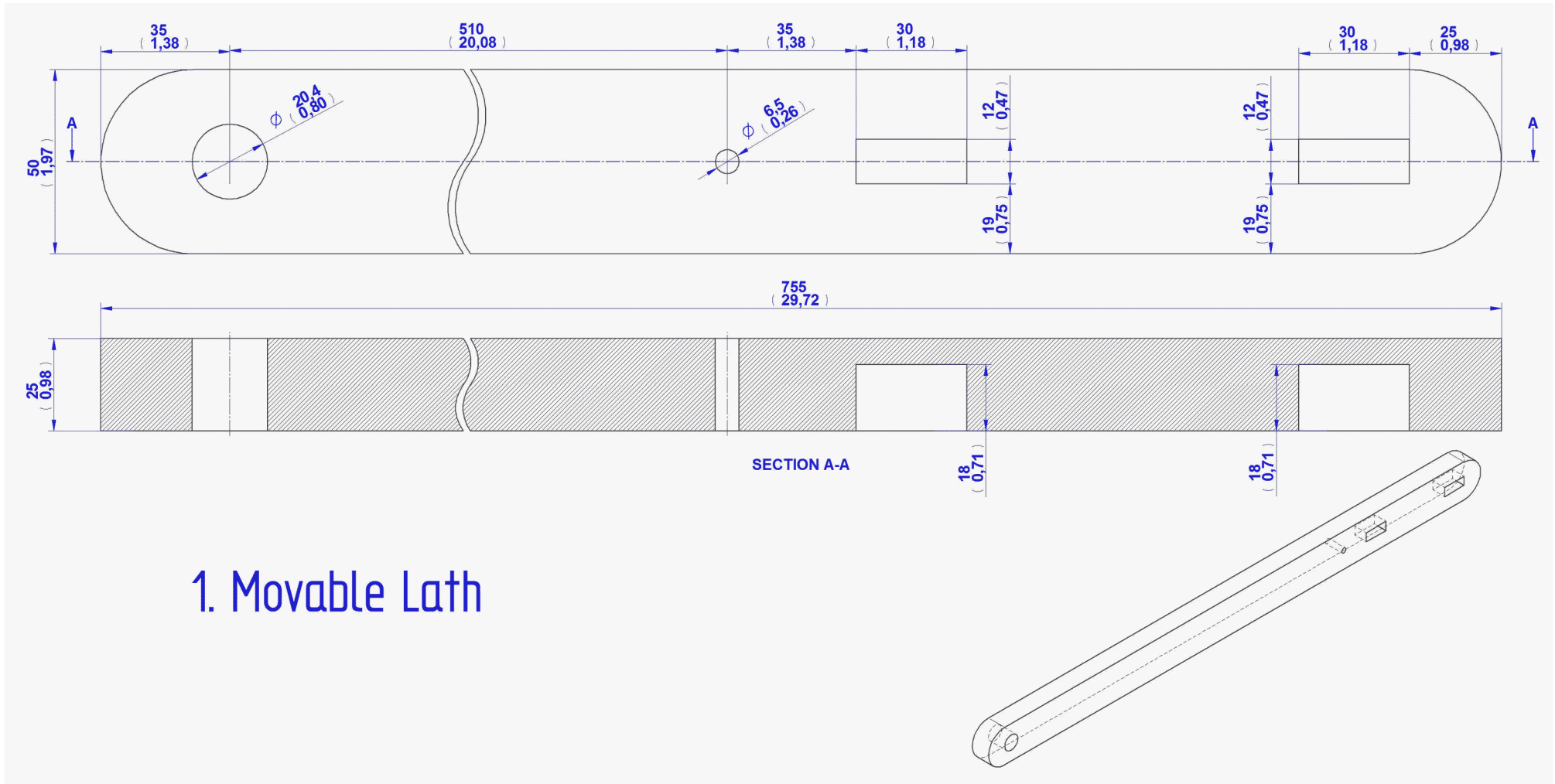

1. Movable Lath

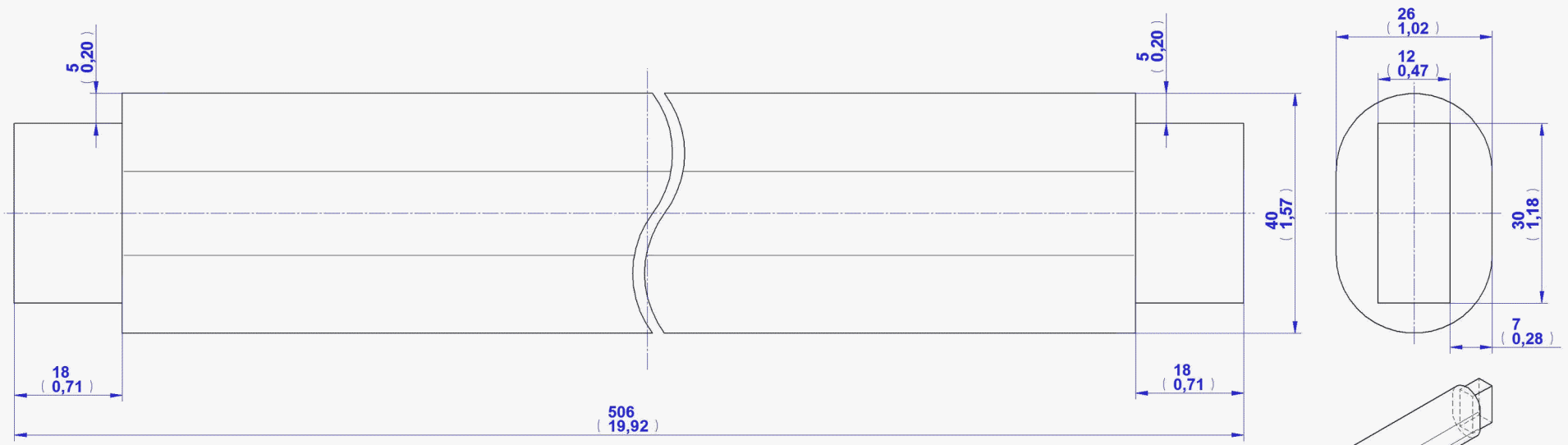

2. Lower Movable Horizontal Lath

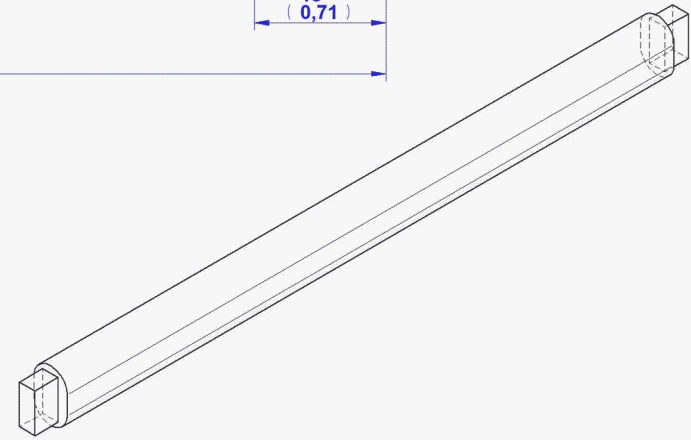

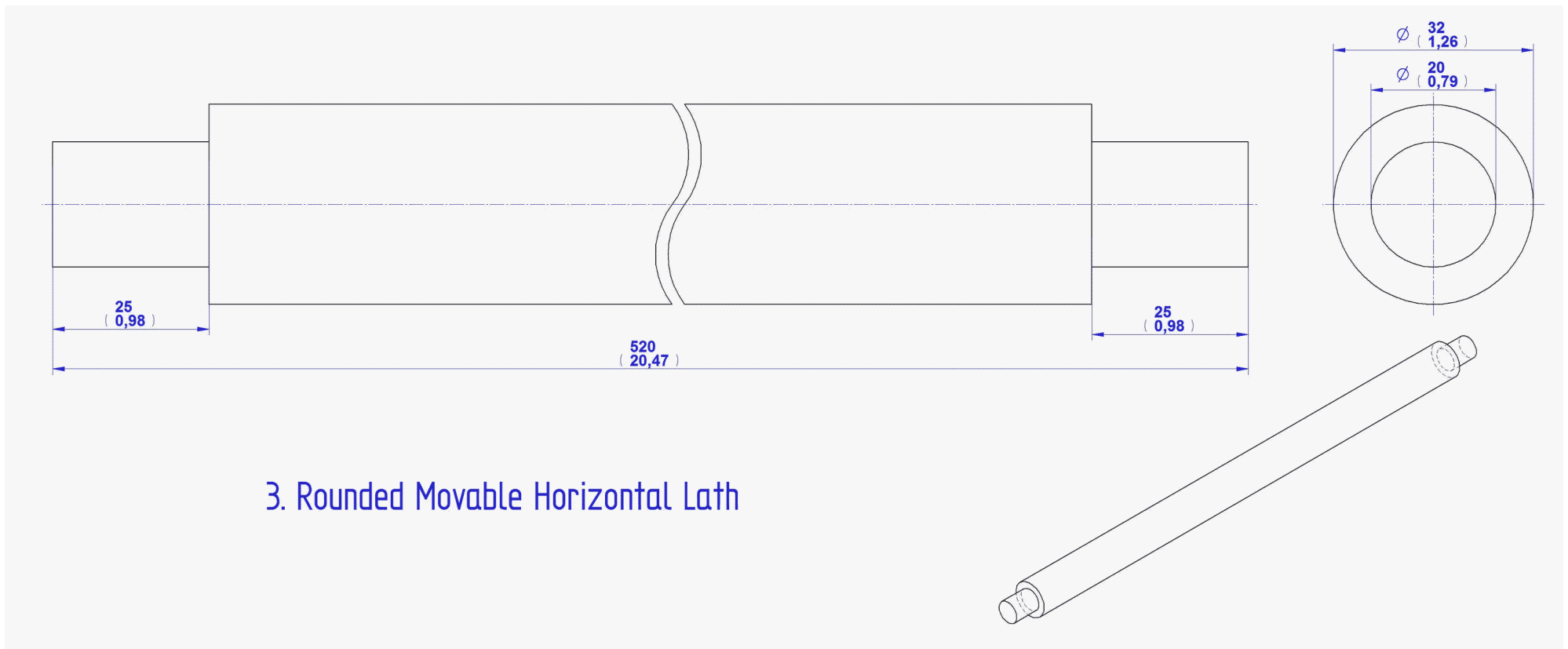

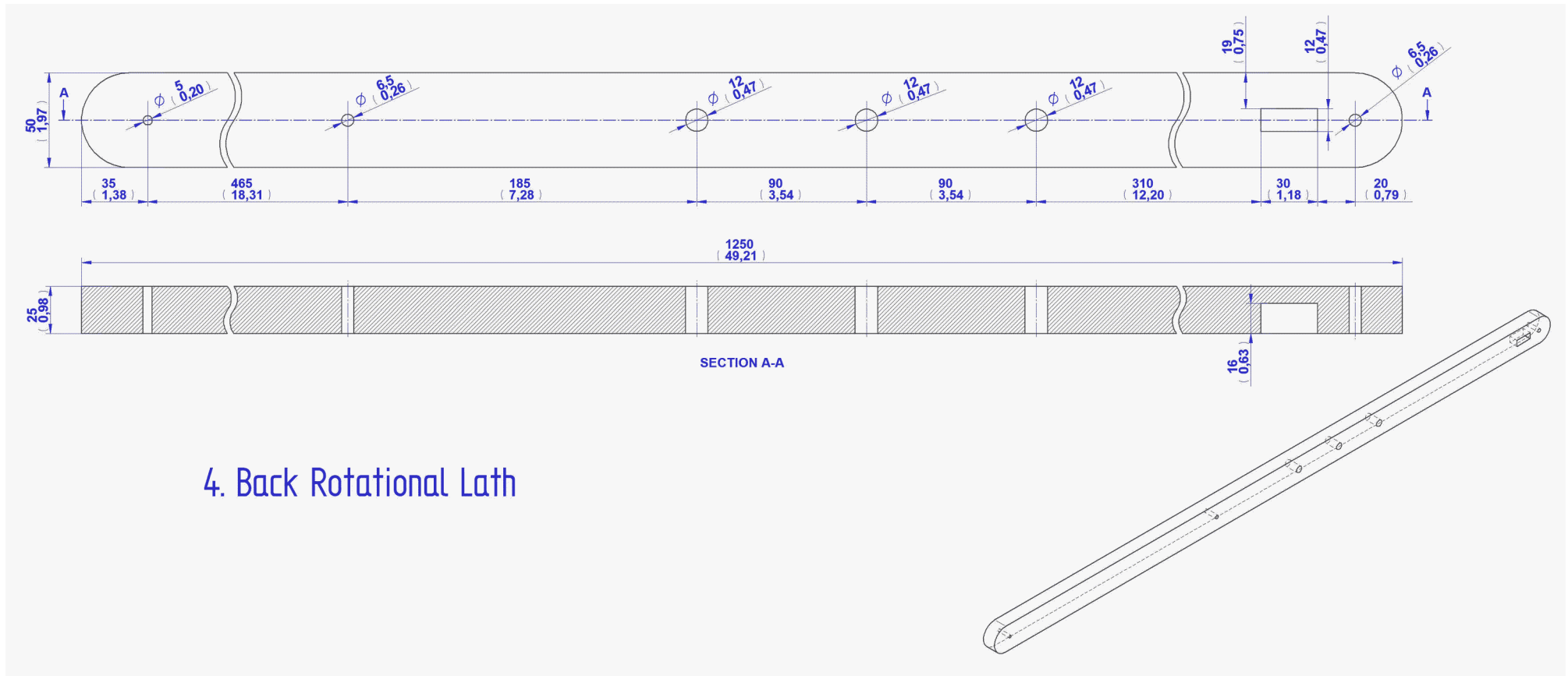

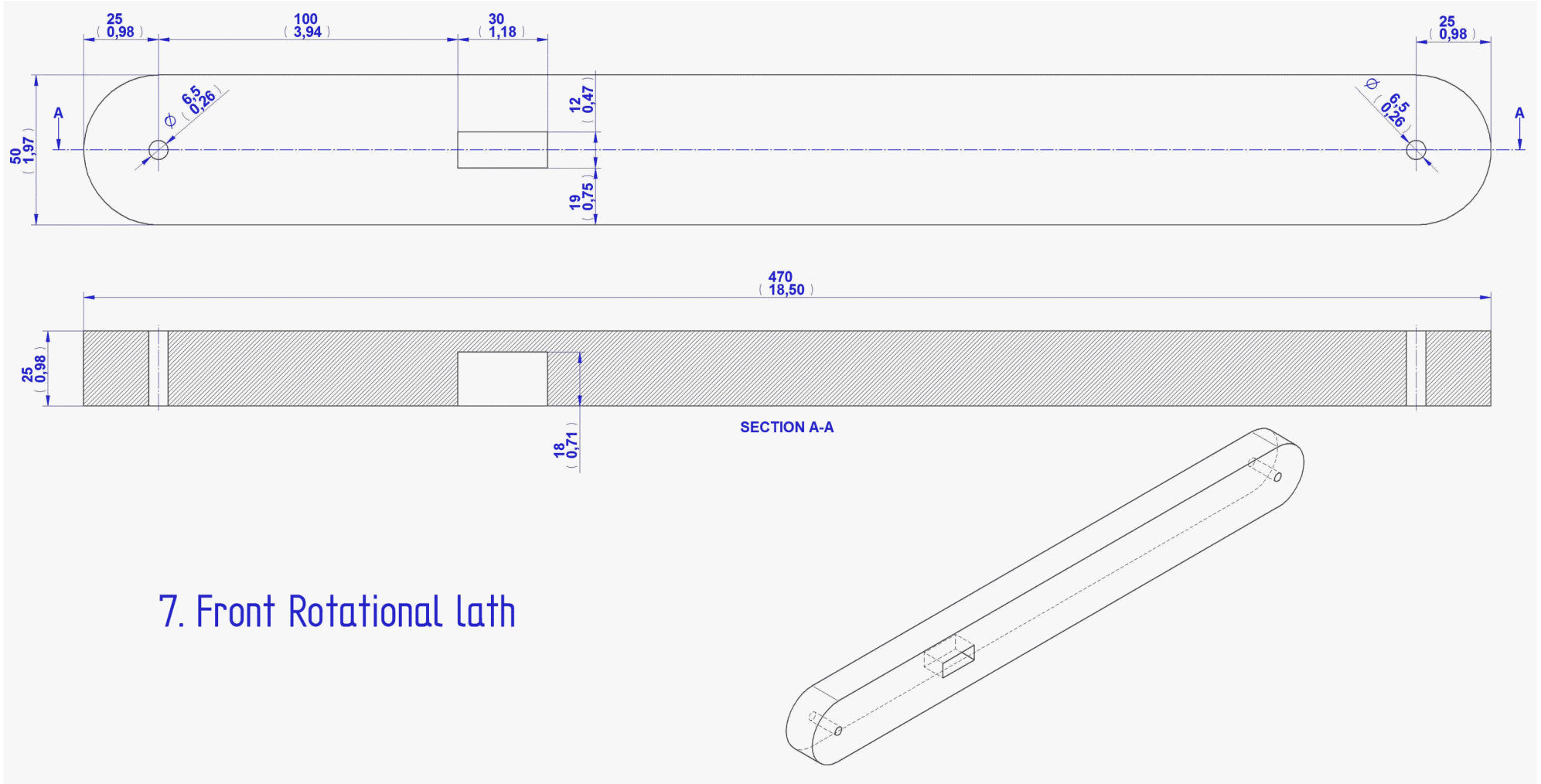

7. Front Rotational lath

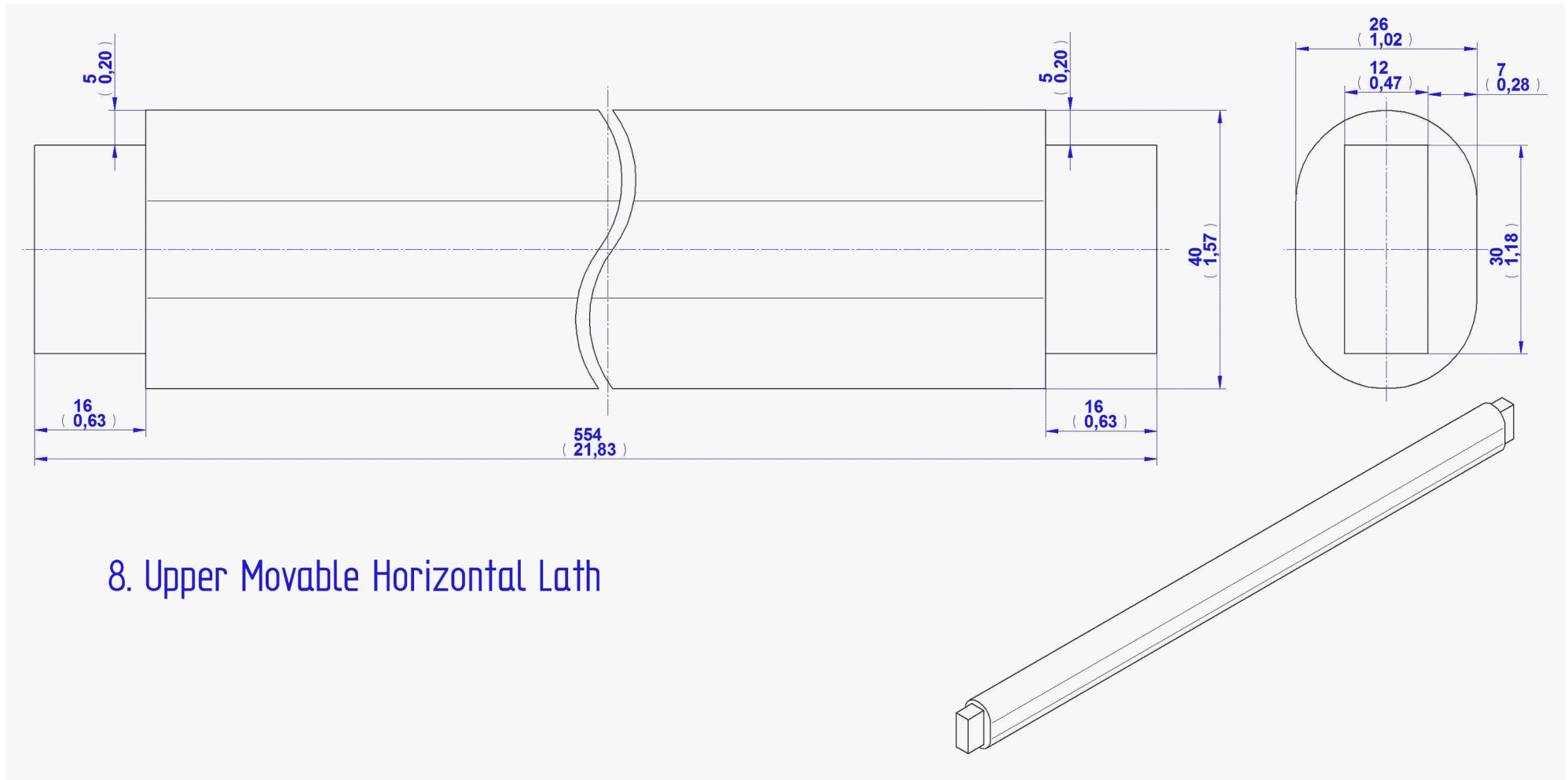

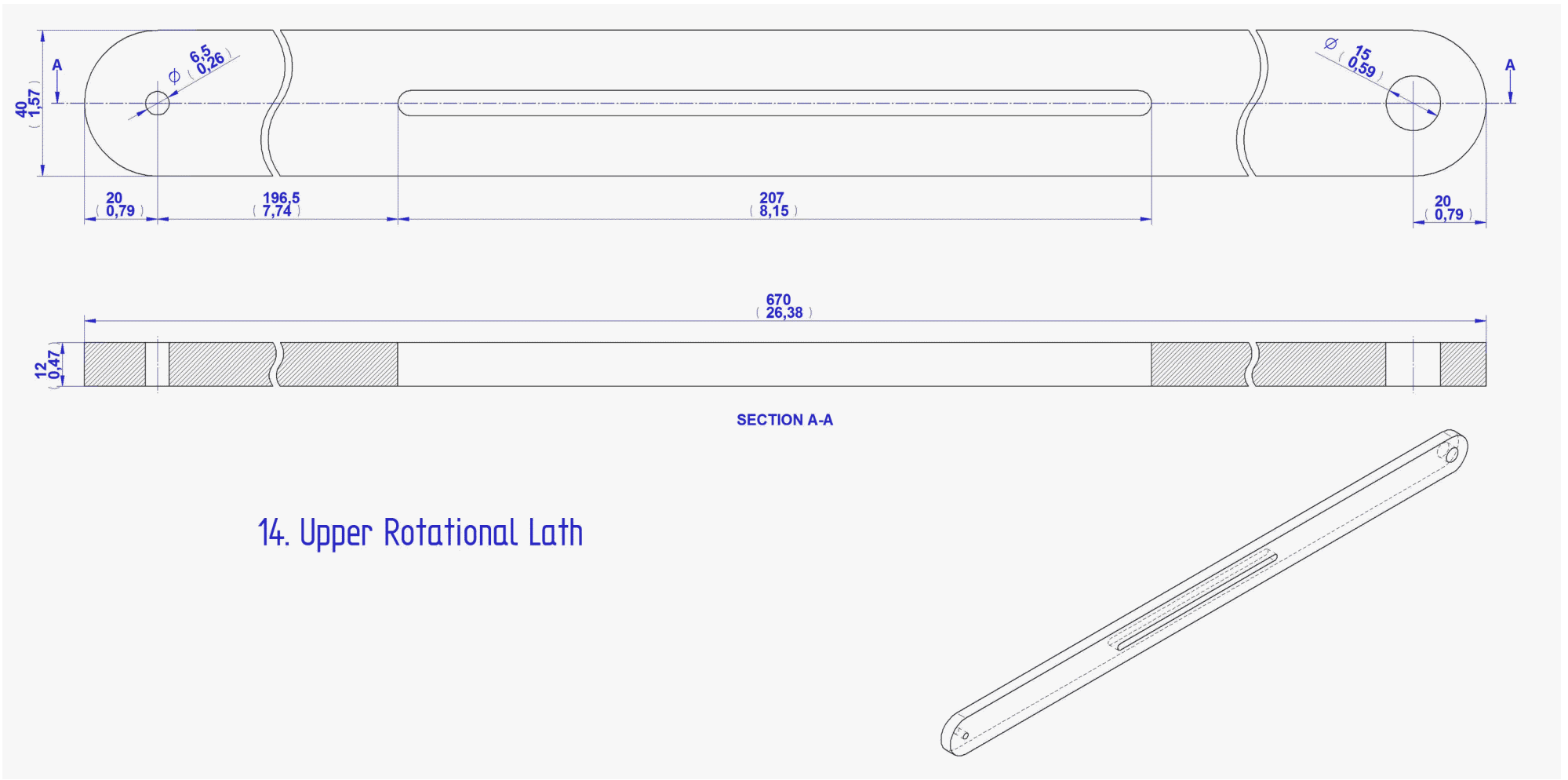

14. Upper Rotational Lath

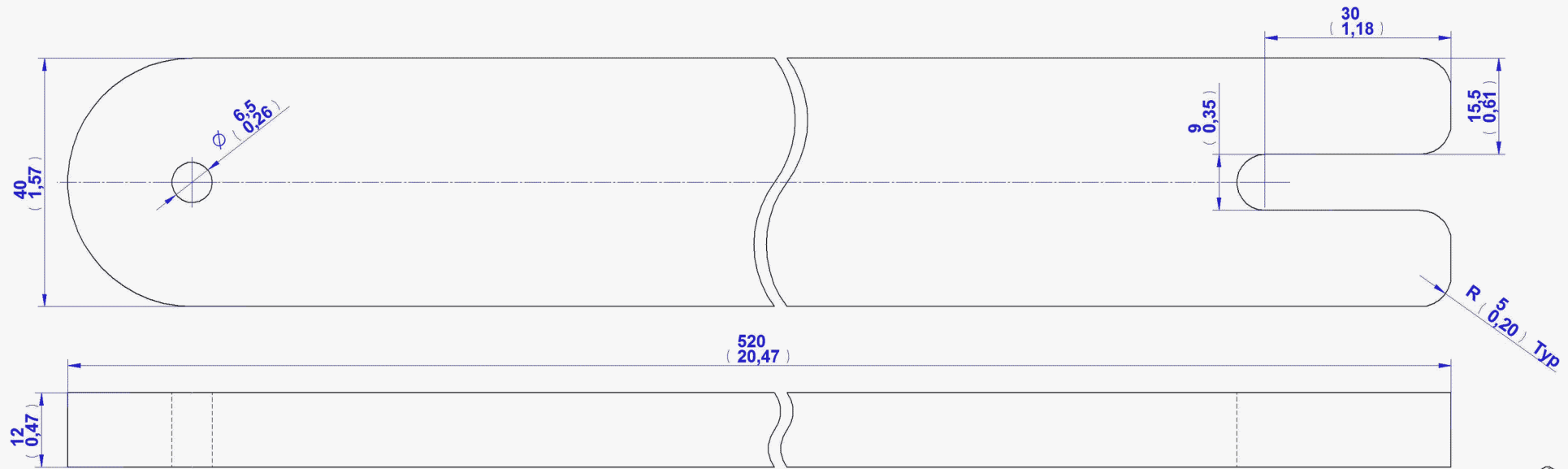

15. Holder Lath

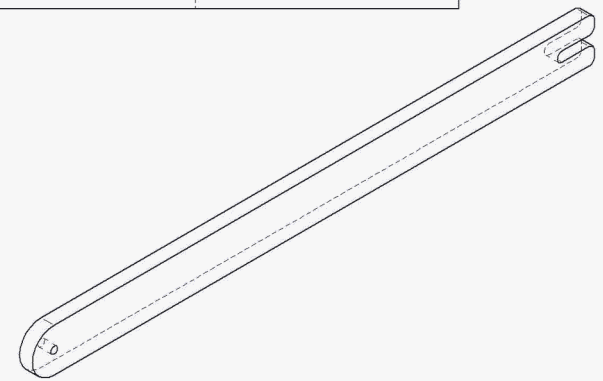

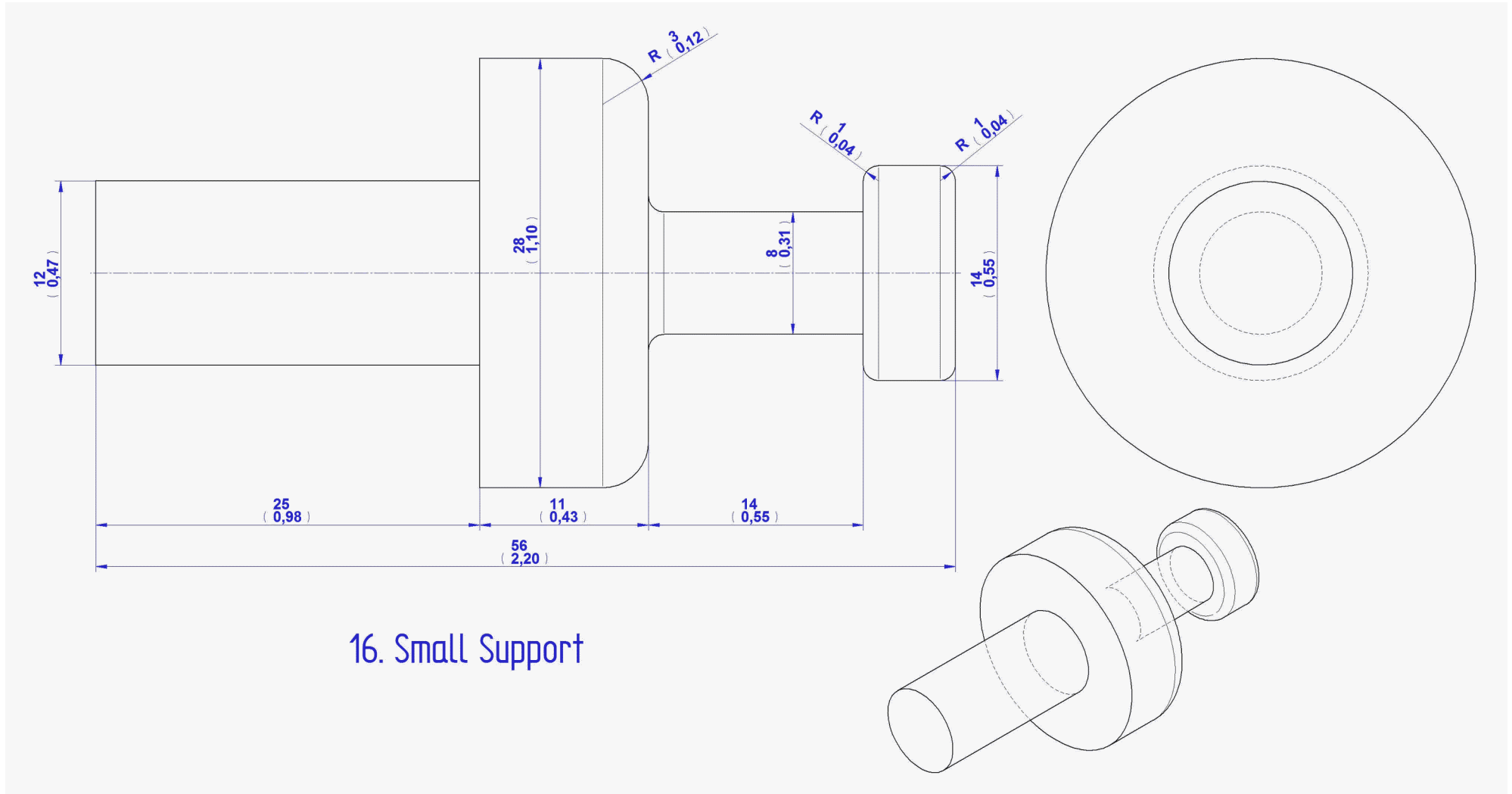

16. Small Support

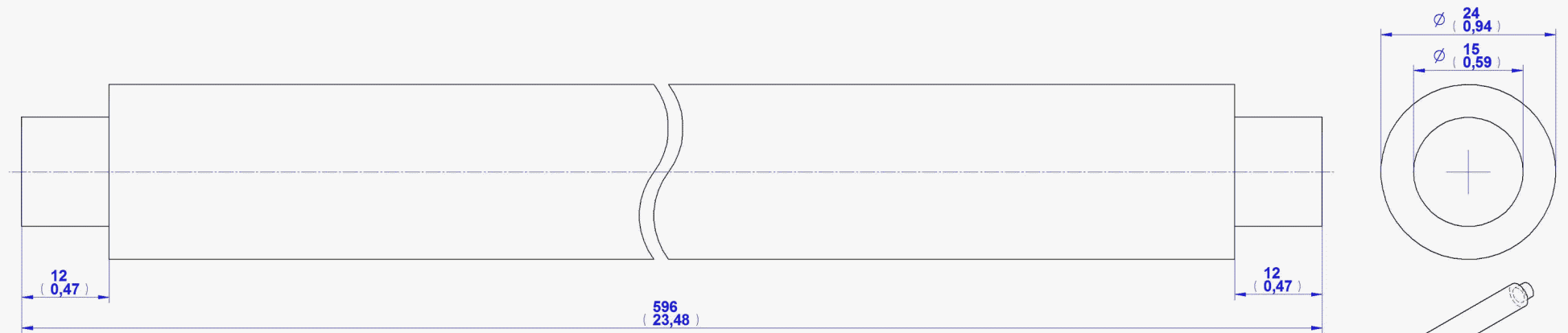

19. Upper Rotational Lath

Movable sub-assembly standard parts

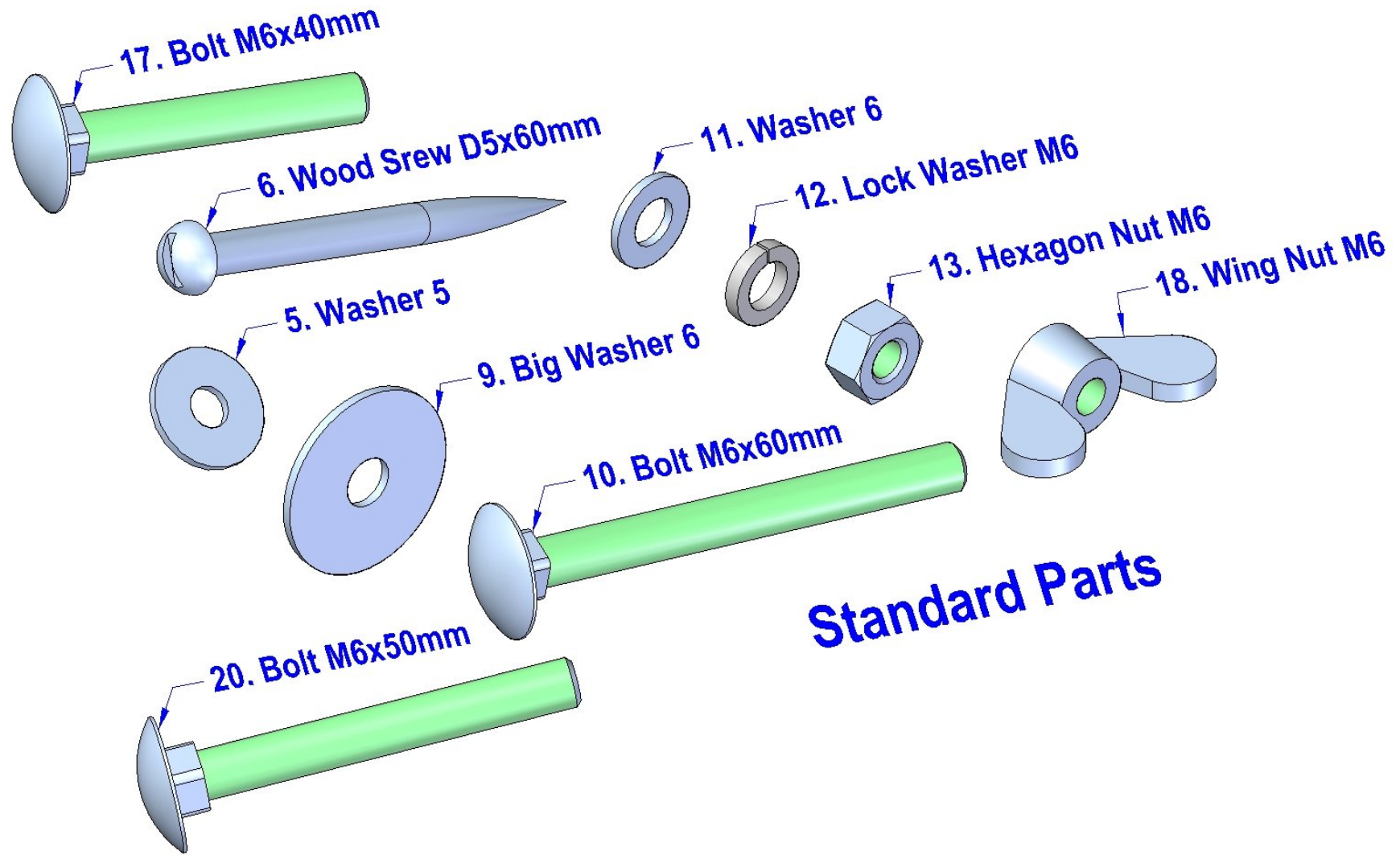

Movable sub-assembly - Assemblage images

1.

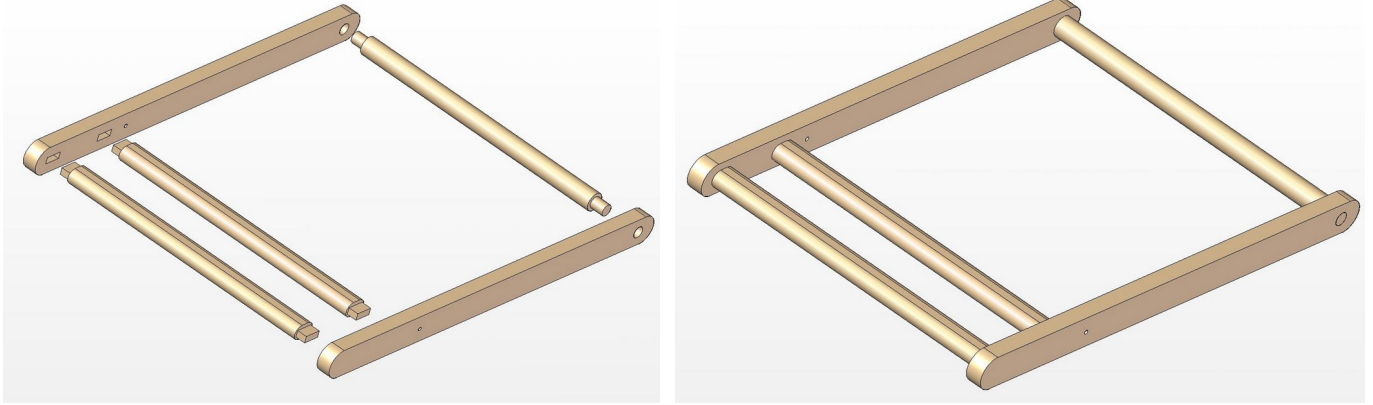

2.

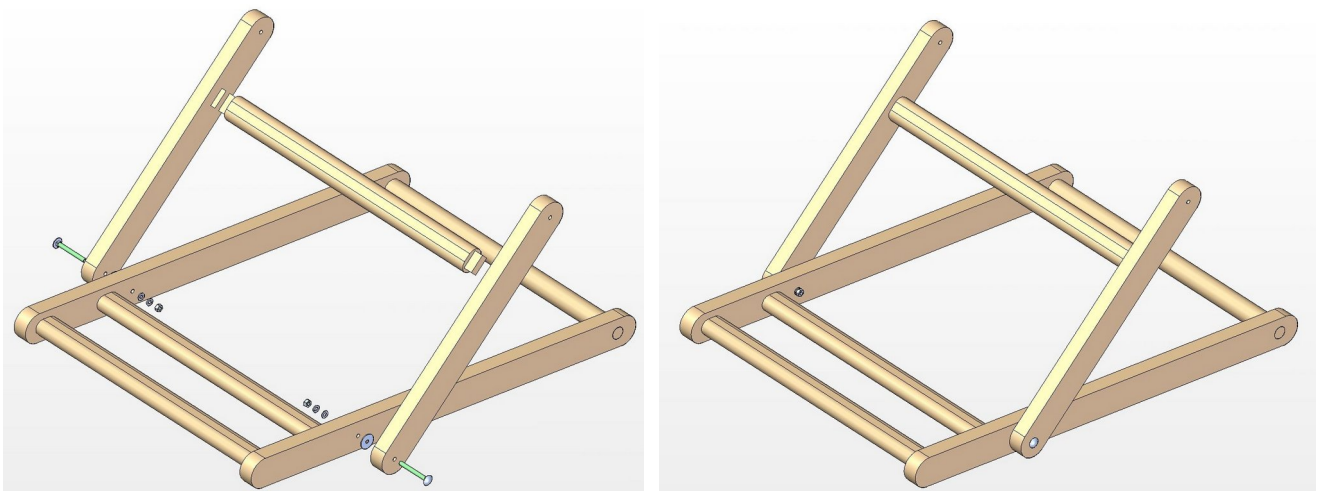

3.

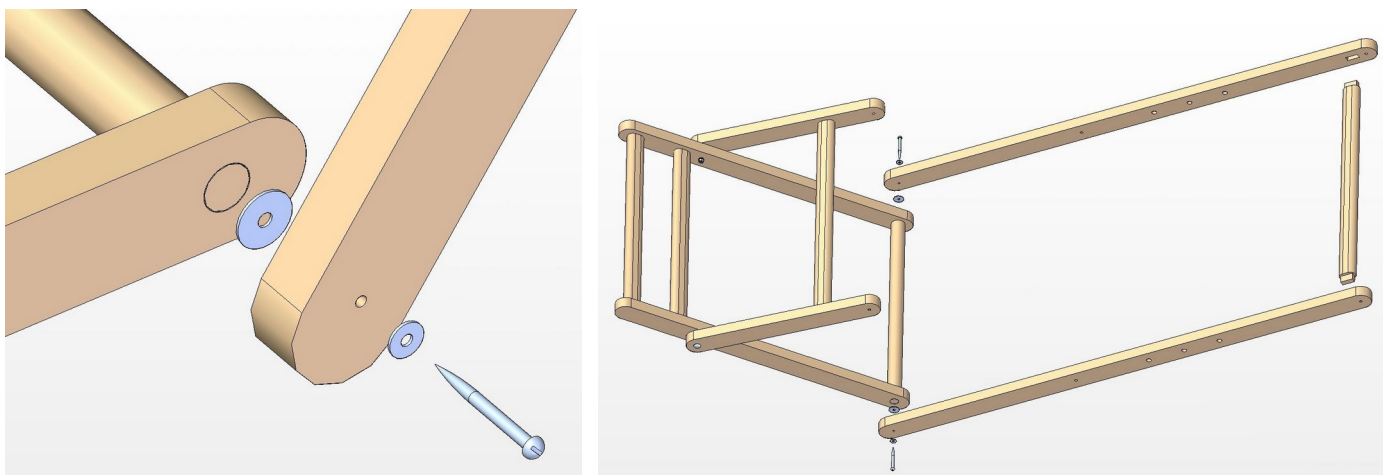

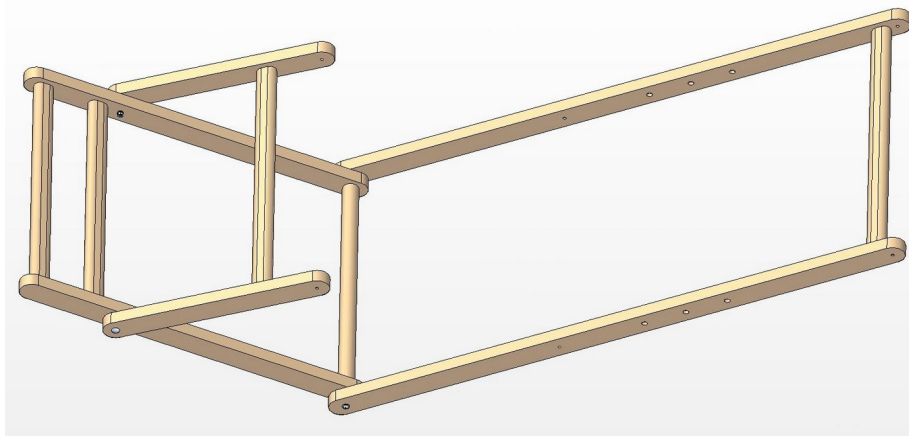

4.

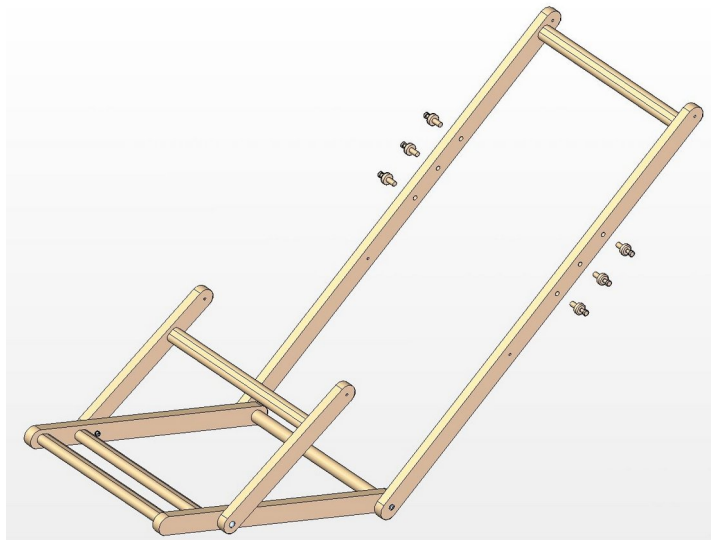
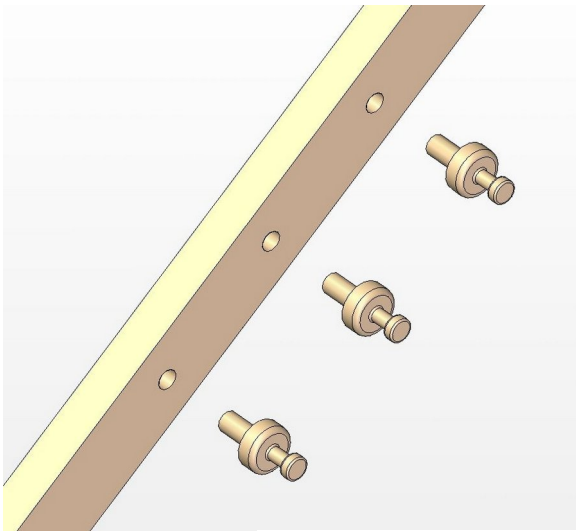

5.

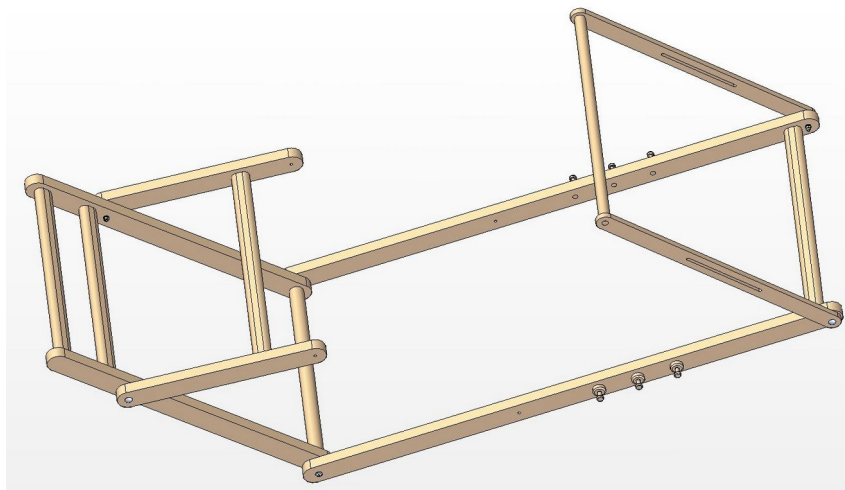
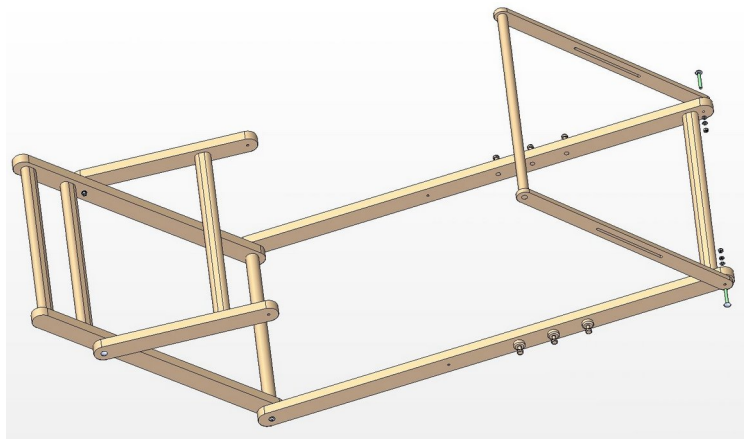
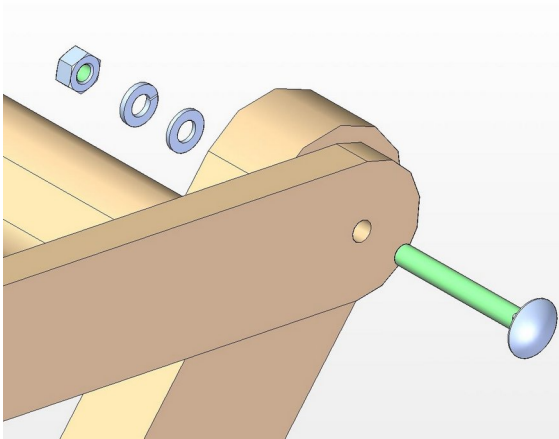

6.

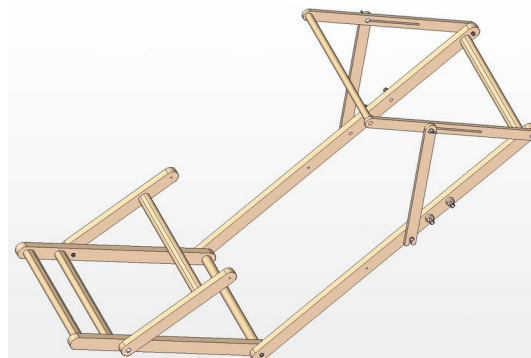
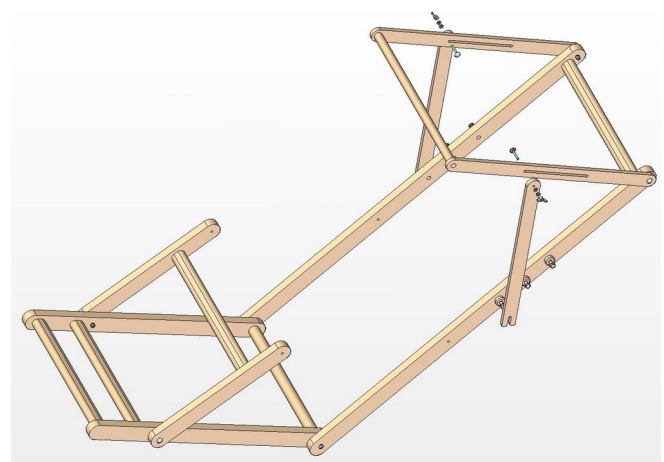
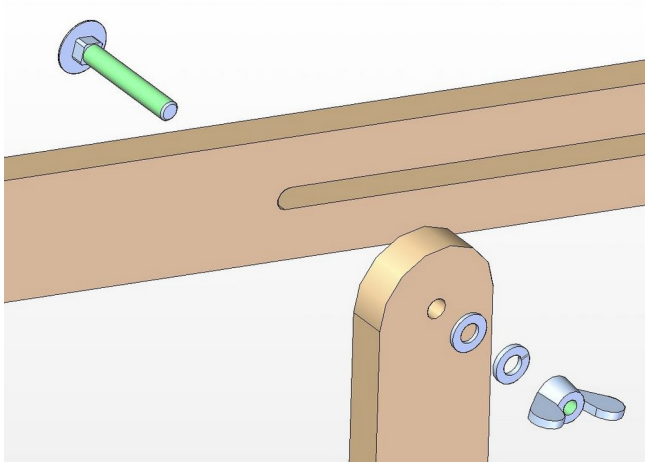

With this procedure, we have finished with the subassemblies construction, and all that is left to do, is to make the main assembly.

1.

